

## Remove the Toner cartridge

△ **CAUTION:** If toner gets on your clothing, wipe it off with a dry cloth and wash clothing in cold water. *Hot water sets toner into fabric.*

1. Press the cartridge-door release button, and then open the cartridge door. Make sure that the door is completely open.

**Figure 2-4** Remove the toner cartridge (1 of 2)



2. Grasp the cartridge handle and pull it out of the product.

△ **CAUTION:** Do not touch the green drum inside the cartridge. Doing so can damage the cartridge. Do not expose the cartridge to strong light.

💡 **Reinstallation tip** Align the print cartridge with its slot and insert the print cartridge until it clicks into place.

**Figure 2-5** Remove the toner cartridge (2 of 2)



## Replace the Transfer roller

△ **CAUTION:** Do not touch the black-sponge portion of the transfer roller. Skin oils deposited on the transfer roller might cause print-quality problems.

1. Press the cartridge-door release button, and then open the cartridge door. Make sure that the door is completely open.

📝 **NOTE:** If you did not remove the print cartridge before servicing the product, remove it now.

**Figure 2-70** Remove the transfer roller (1 of 3)

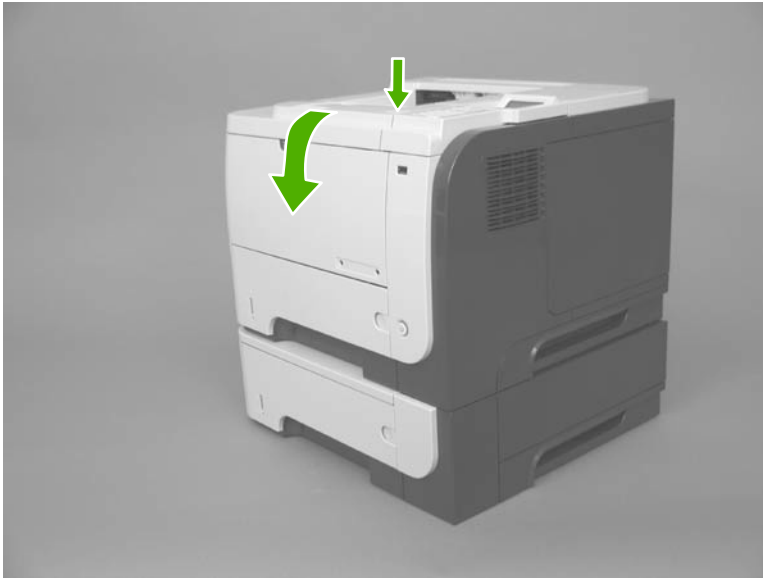

2. Release two tabs (callout 1) at the left end of the roller, slightly lift the end of the roller up, and then slide the roller (callout 2) toward the left to release it. Remove the roller.

**Figure 2-71** Remove the transfer roller (2 of 3)

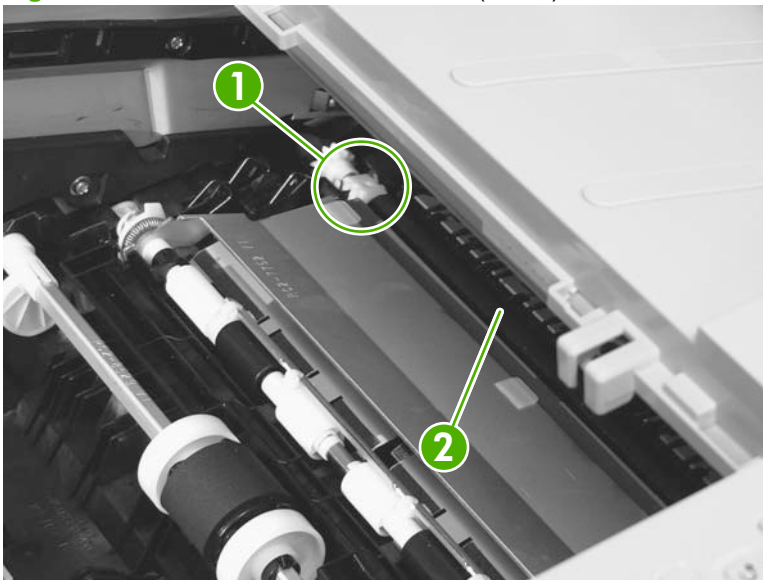

3. If necessary, remove the gear, the bushing, and the spring, and then install them on a replacement roller.

**Figure 2-72** Remove the transfer roller (3 of 3)

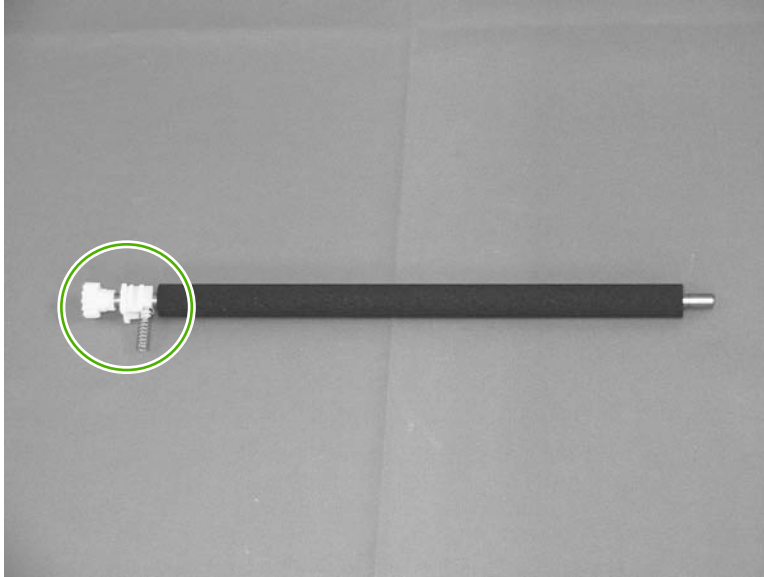

## Replace the Tray 1 (multipurpose tray) pickup roller

△ **CAUTION:** Do not touch the surface of the roller. Skin oils deposited on the roller might cause print-quality problems.

1. Press the cartridge-door release button, and then open the cartridge door. Make sure that the door is completely open.

**Figure 2-60** Remove the Tray 1 (MP tray) pickup roller (1 of 2)

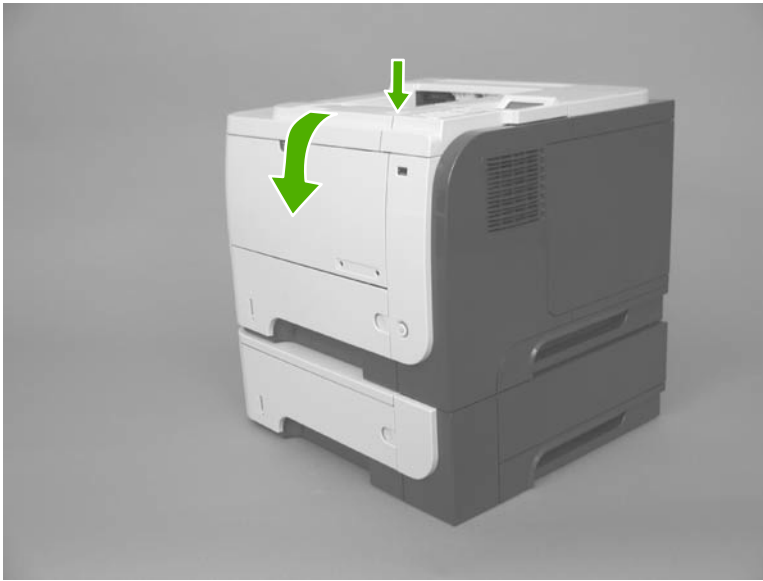

2. Release two tabs, and then rotate the roller out and away from the product to remove it.

💡 **TIP:** It might be easier to release the tabs by using a small flat blade screwdriver.

**Figure 2-61** Remove the Tray 1 (MP tray) pickup roller (2 of 2)

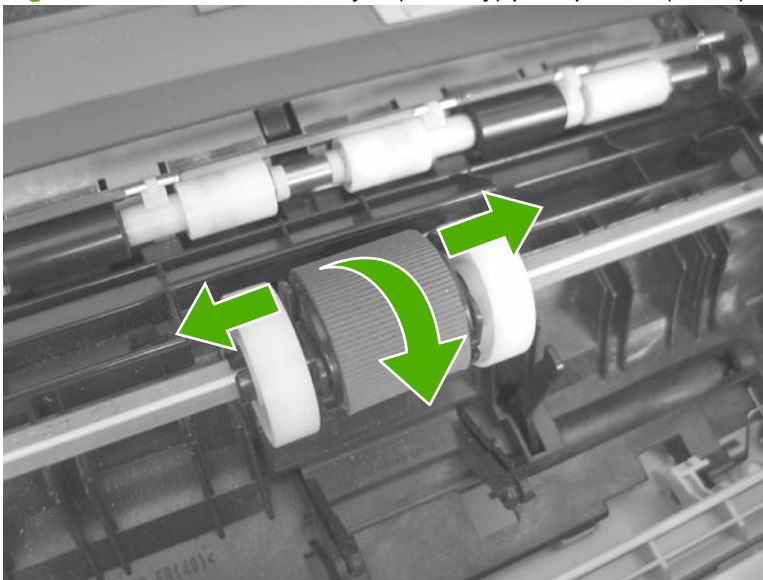

## Replace the Tray 1 (multipurpose tray) separation pad

△ **CAUTION:** Do not touch the surface of the pad. Skin oils deposited on the roller might cause paper-handling problems.

1. Press the cartridge-door release button, and then open the cartridge door. Make sure that the door is completely open.

**Figure 2-62** Remove the Tray 1 (multipurpose tray) separation pad (1 of 2)



2. Release two tabs (callout 1), and then remove the separation pad.

**Figure 2-63** Remove the Tray 1 (multipurpose tray) separation pad (2 of 2)

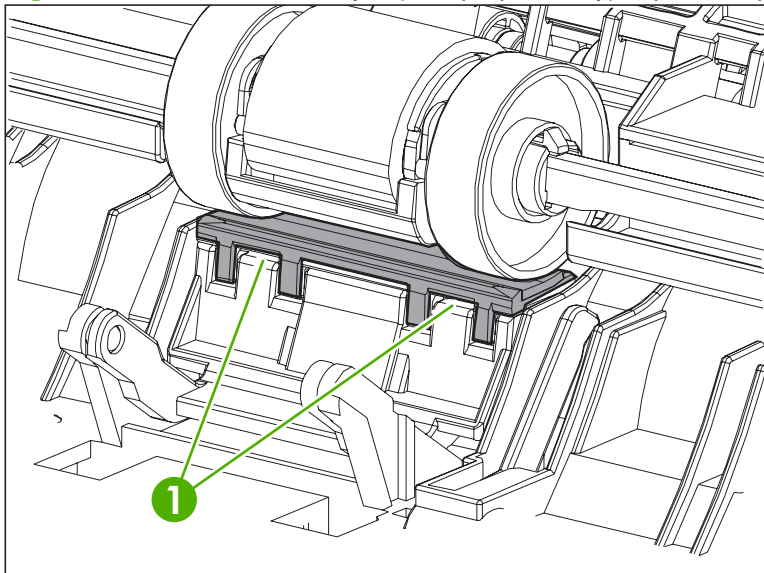

## Remove the Tray 2 cassette

 **NOTE:** Use this procedure to remove the Tray 2 cassette.

---

1. Pull the tray straight out of the product until it stops.

**Figure 2-6** Remove the tray cassette (1 of 2)



2. Carefully lift up on the tray to release it, and then remove the tray.

**Figure 2-7** Remove the tray cassette (2 of 2)

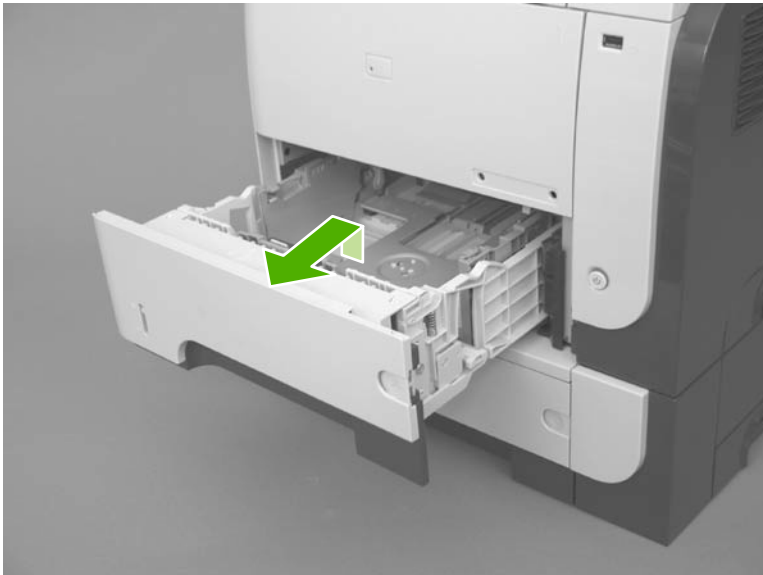

## Replace the Tray 2 pickup roller

△ **CAUTION:** Do not touch the surface of the roller. Skin oils deposited on the roller might cause print-quality problems.

📝 **NOTE:** If you did not remove the Tray 2 cassette before servicing the product, remove it now.

1. Carefully place the product front-side up, so that you can see into the opening where the cassette would be installed.

📝 **NOTE:** Debris can scratch or damage the back of the product. Before you place the product front-side up, remove any debris from the work surface. If possible, set the product on a clean, dry cloth to prevent scratching and damage.

2. Release the roller bushing, rotate the bushing up, and then slide the bushing off of the roller shaft.

**Figure 2-64** Remove the Tray 2 pickup roller (1 of 3)

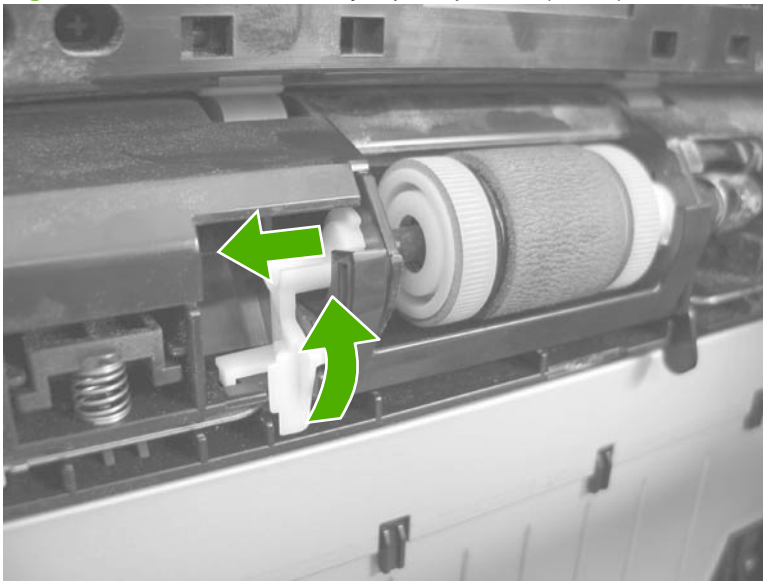

- Carefully remove the black-plastic guard (callout 1).

△ **CAUTION:** The guard is partially retained by the bushing removed in the previous step. Do not lose the guard when the bushing is removed.

**Figure 2-65** Remove the Tray 2 pickup roller (2 of 3)

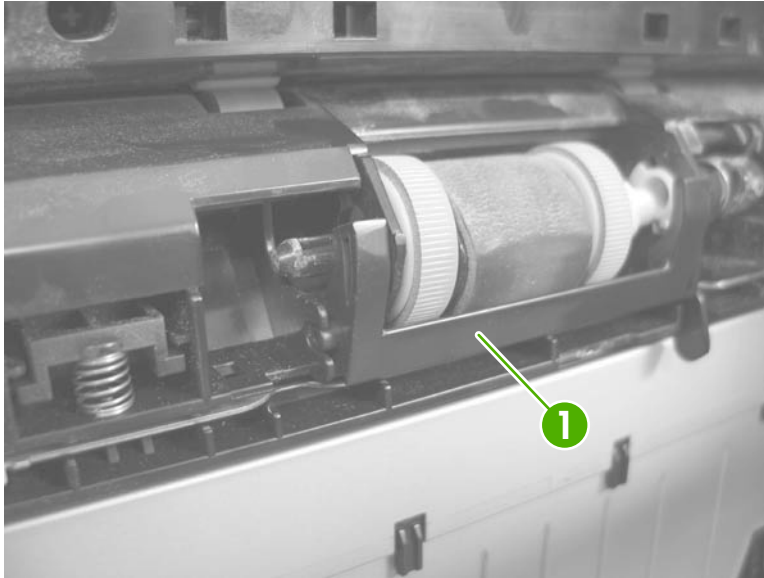

- Slide the roller toward the left side of the product, rotate the right end of the roller away from the product, and then remove the roller assembly.

**Figure 2-66** Remove the Tray 2 pickup roller (3 of 3)

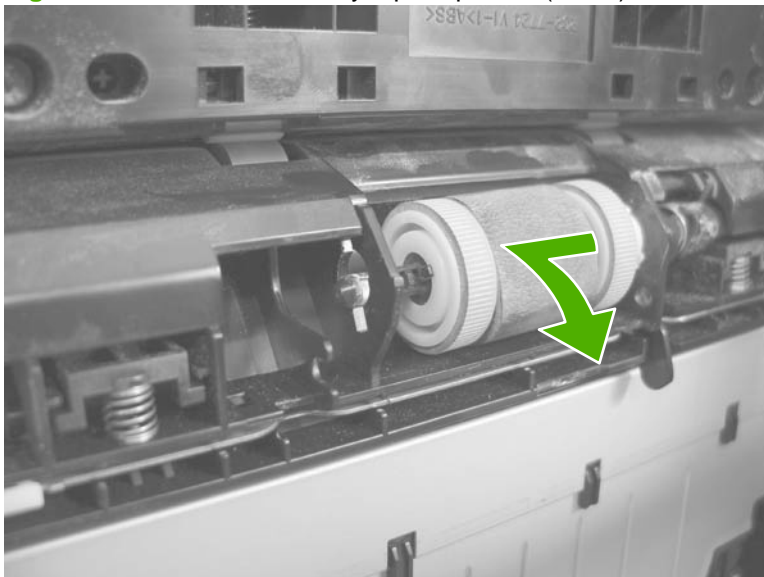



## Replace the Tray 2 separation pad

△ **CAUTION:** Do not touch the surface of the pad. Skin oils deposited on the roller might cause paper-handling problems.

1. If you haven't yet done so, remove the tray cassette.
2. Remove two screws (callout 1), and then remove the separation pad (callout 2).

**Figure 2-67** Remove the Tray 2 separation pad

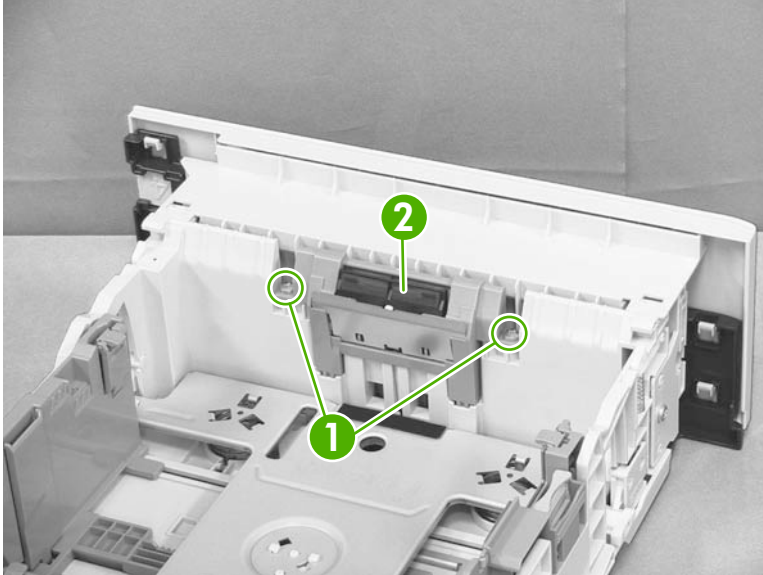

## Remove the rear-door assembly

1. Open the rear door.

**Figure 2-20** Remove the rear-door assembly (1 of 8)



2. Gently pull down on the door and lower the door until it is fully open.

**Figure 2-21** Remove the rear-door assembly (2 of 8)

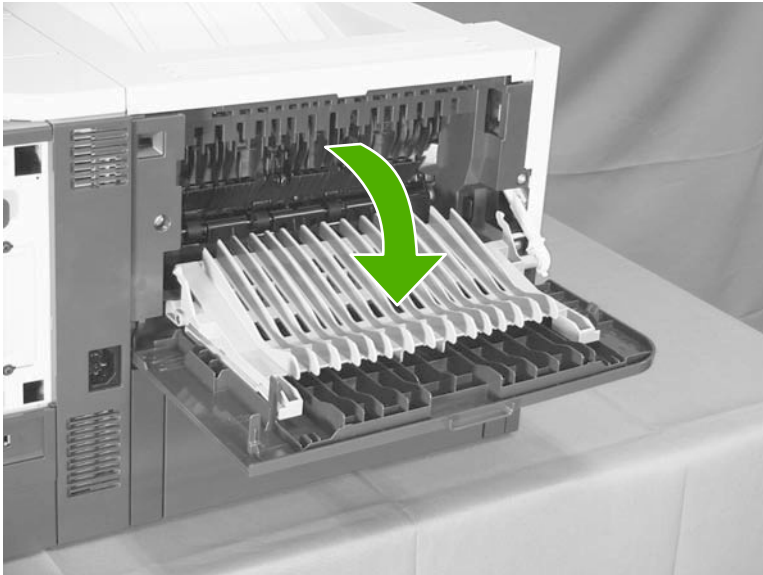

3. Push up on the link arm to release it.

△ **CAUTION:** The link arm is under spring tension. Do not let the link arm snap back toward the product when you release it.

**Figure 2-22** Remove the rear-door assembly (3 of 8)

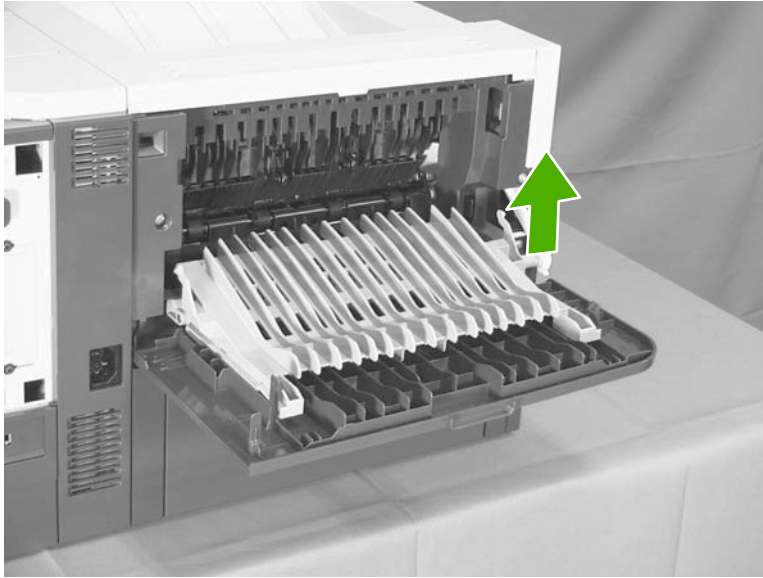

4. Remove two screws (callout 1).

**Figure 2-23** Remove the rear-door assembly (4 of 8)

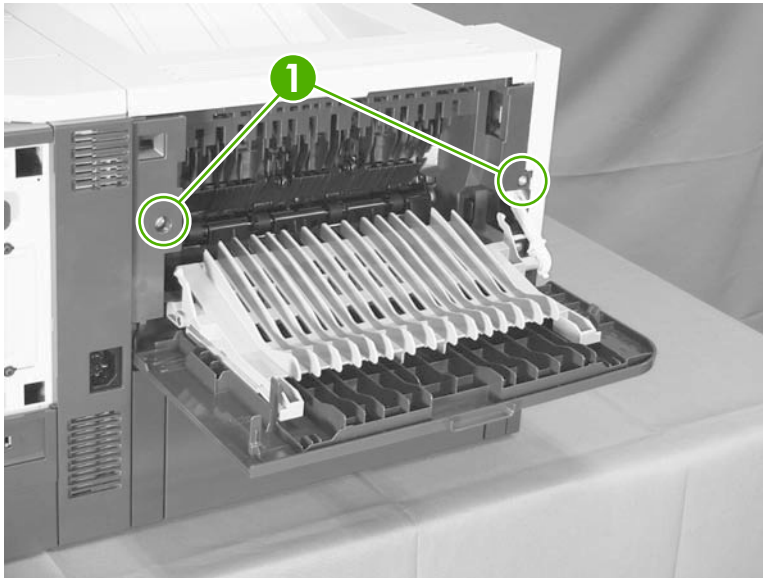

5. Open the lower-rear door, and then release one tab (callout 1).

**Figure 2-24** Remove the rear-door assembly (5 of 8)

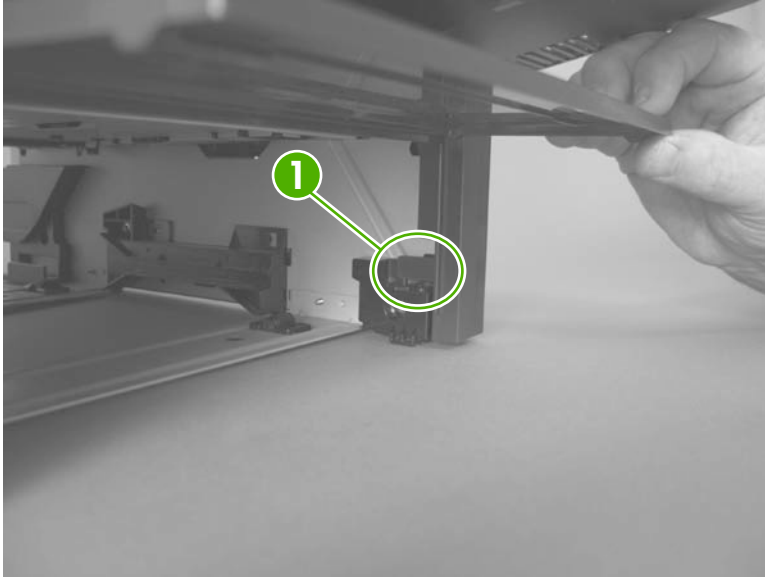

6. Release one tab (callout 1).

**Figure 2-25** Remove the rear-door assembly (6 of 8)

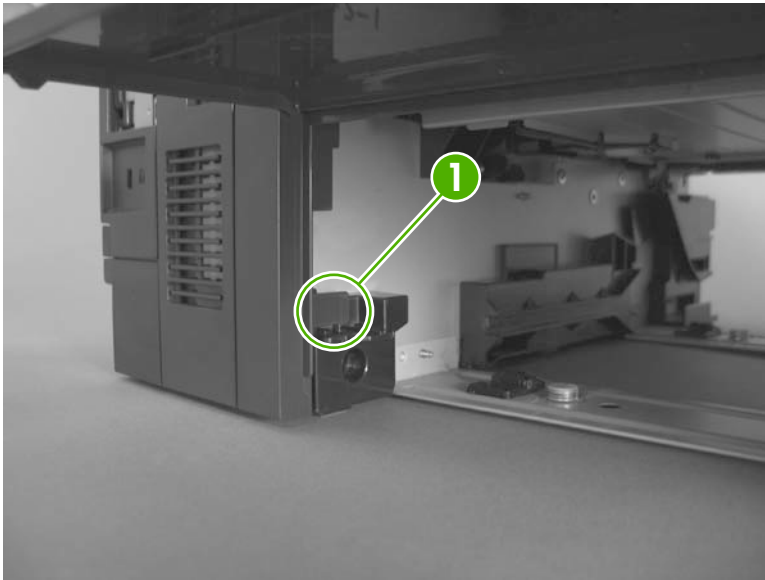

7. Rotate the bottom of the rear-door assembly away from the product.

**Figure 2-26** Remove the rear-door assembly (7 of 8)

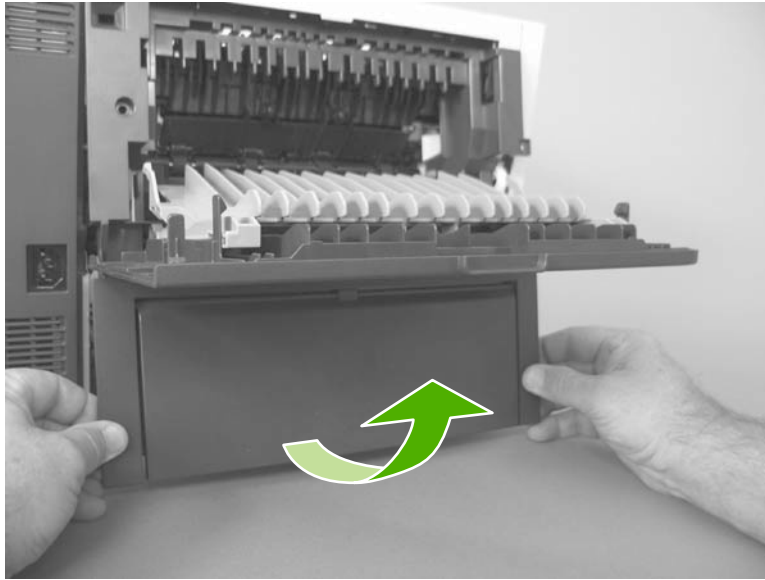

8. Pull down on the rear-door assembly to remove it.

**Figure 2-27** Remove the rear-door assembly (8 of 8)

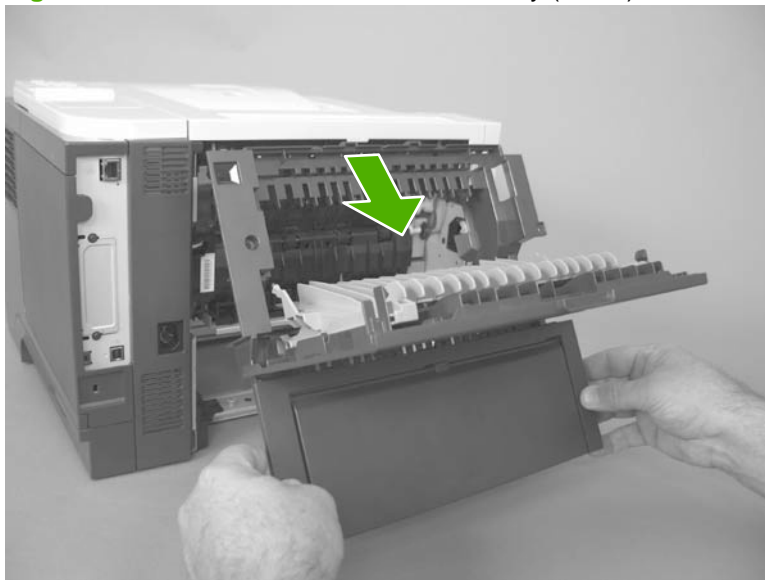

## Remove the Right-rear cover

1. If you haven't yet done so, remove the rear-door assembly. (Previous step)
2. Slide the right-rear cover toward the inside of the product to release it.

**Figure 2-32** Remove the right-rear cover (1 of 2)



3. Rotate the bottom of the cover away from the product, and then pull down on the cover to remove it.

**Figure 2-33** Remove the right-rear cover (2 of 2)

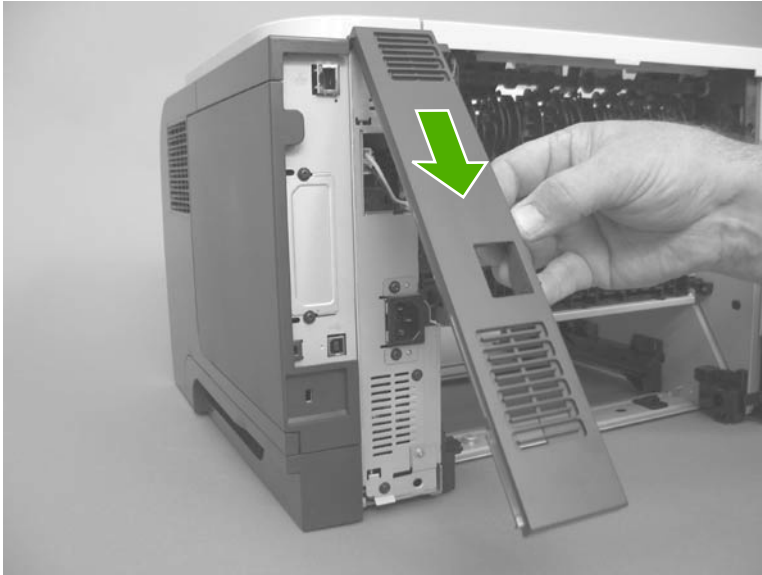

## Fuser

1. Before proceeding, remove the following components:
  - Rear-door assembly.
  - Right-rear cover.
2. **Duplex models only:** Release two tabs (callout 1) on the duplex media-feed guide, and then slide the guide toward the back of the product to remove it.

 **Reinstallation tip** Make sure that both tabs snap back into place when reinstalling the duplex media-feed guide.

**Figure 2-81** Remove the fuser (1 of 4)

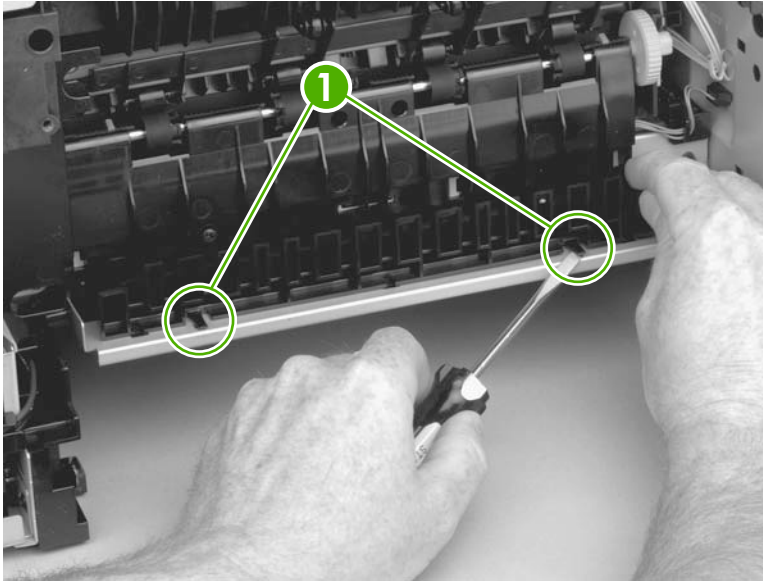

3. Disconnect three connectors (callout 1), and release one wire harness from the retainer (callout 2).

**Figure 2-82** Remove the fuser (2 of 4)

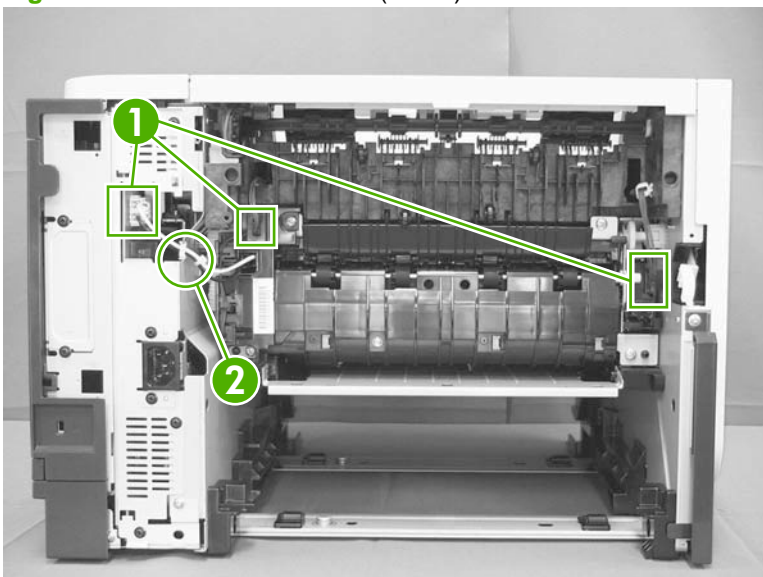

4. Remove four screws (callout 1).

**Figure 2-83** Removing the fuser (3 of 4)

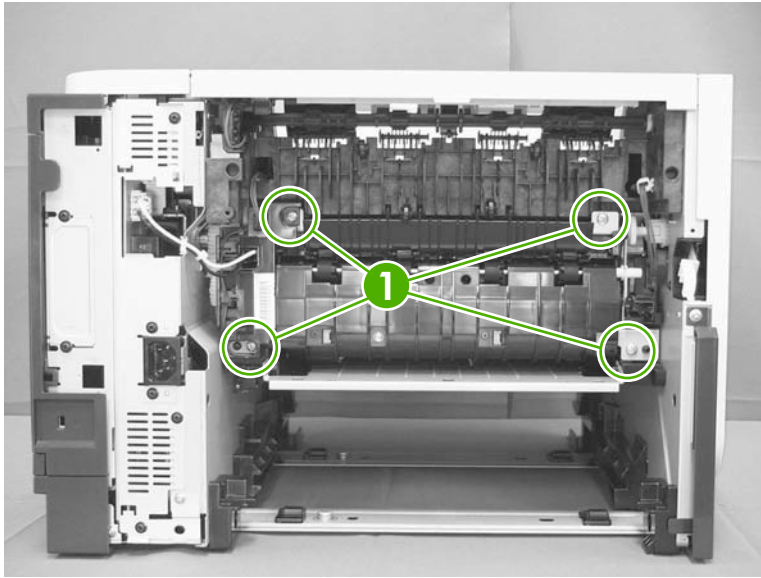

5. Pull the fuser out of the back of the product.

△ **CAUTION:** To avoid damaging the fuser, the cartridge-door assembly must be closed before you remove the fuser.

**Figure 2-84** Removing the fuser (4 of 4)

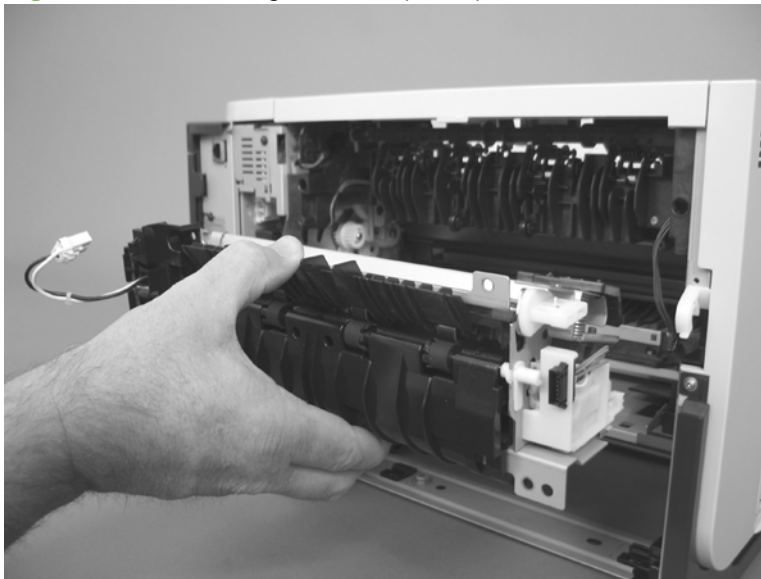

6. Install the new fuser in reverse order of these steps.

If you purchased this kit on exchange, don't forget to send back your old fuser to us.

Re-use the same packaging and include a copy of the RMA form with your return.