

HP LaserJet P2015 series Maintenance Kit Instructions

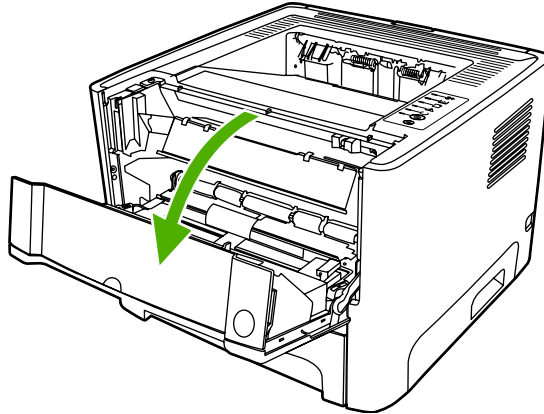

Replace the pickup roller and separation pad (Tray 1)

1. Press the print-cartridge-door button to open the print-cartridge door.



2. Remove the print cartridge. After removing the print cartridge, only handle it on the ends.
3. Grasping the pickup-roller cover with thumb and forefinger, squeeze the left side of the pickup-roller cover to release the left retaining tab, and then slide the cover to the left and up.

 **CAUTION** Failure to slide the cover to the left when removing it can cause the right retaining tab to break.

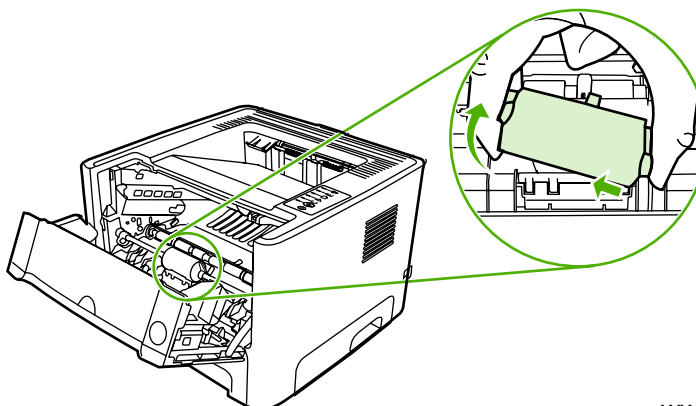
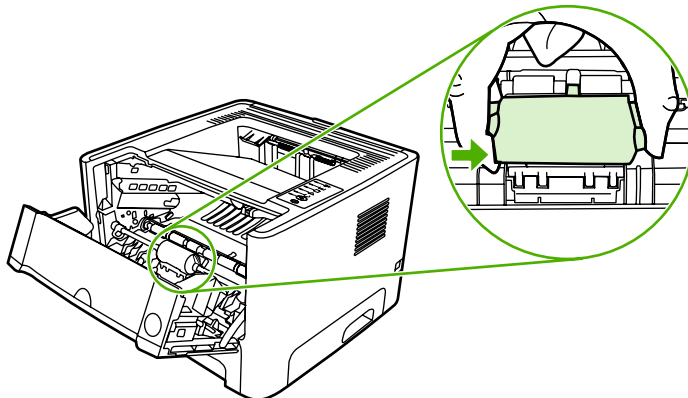

4. Press the two black retaining tabs outward until the pickup roller is released from its seat.

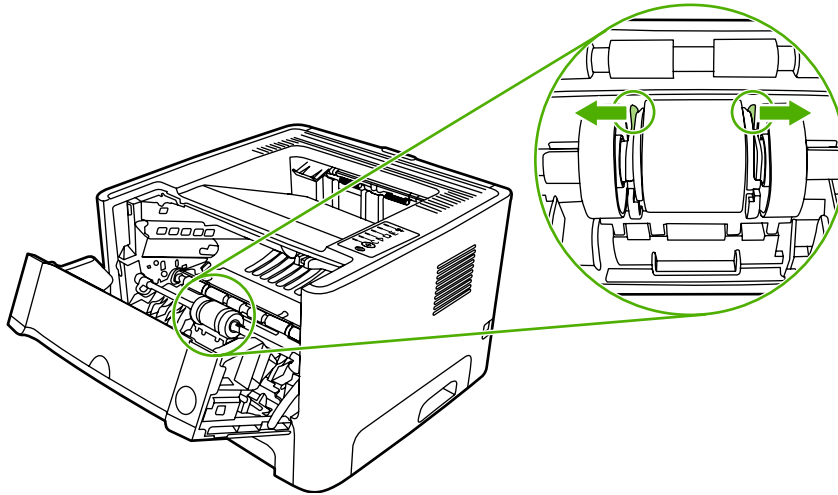

5. Remove the old pickup roller from the printer.

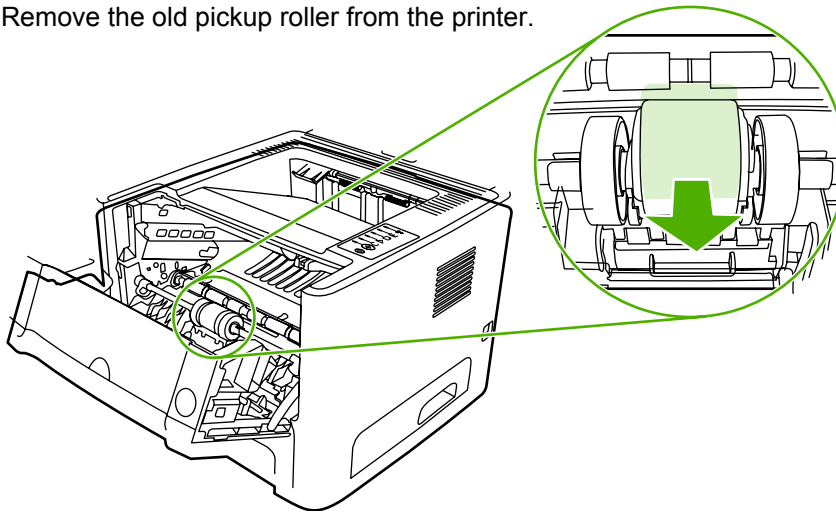

6. Insert a flatblade screwdriver under the old separation pad and pry up to remove it.

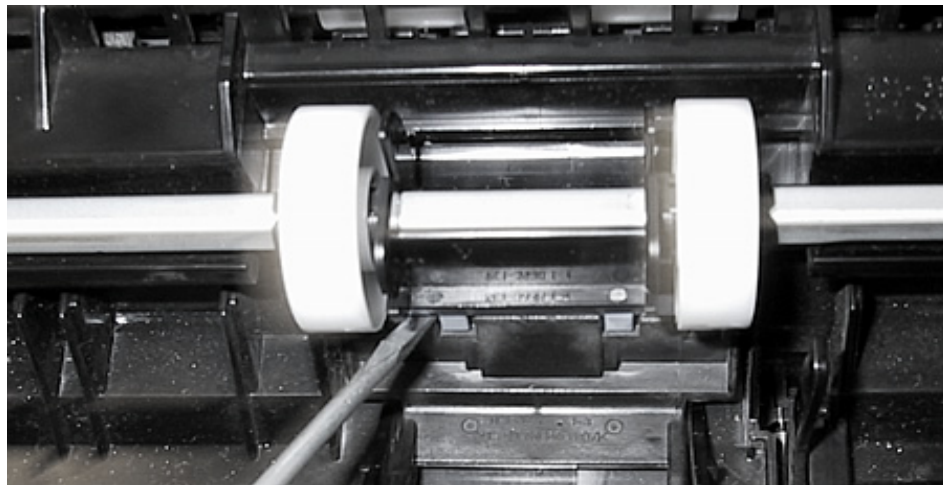

7. Install the new separation pad. Insert as shown in picture below, then use the flatblade of your screwdriver (or your fingers) to firmly press down and lock both sides of the separation pad.

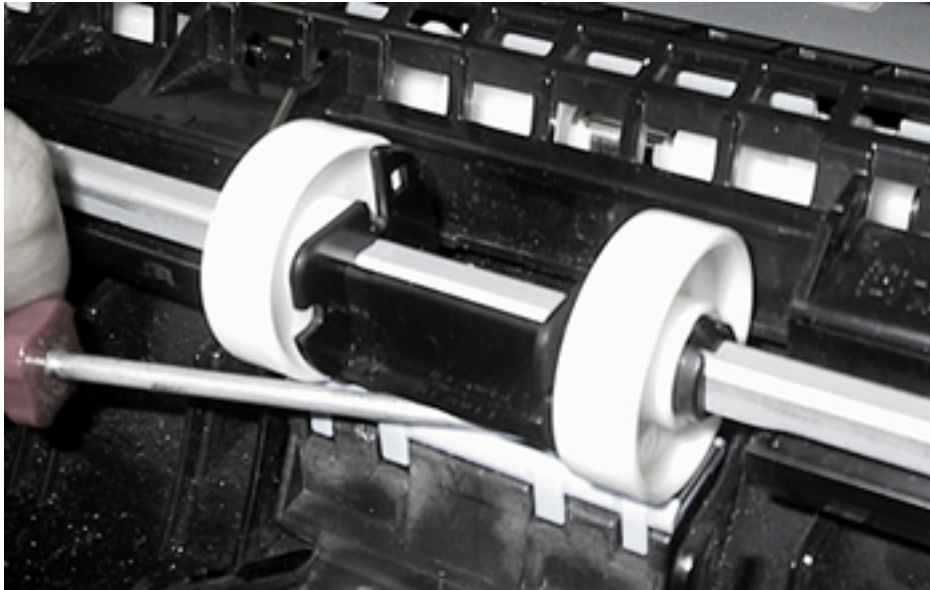

8. Line up the black retaining tabs in the printer with the grooves in the new pickup roller, and then press the pickup roller into the pickup-roller seat until the retaining tabs click.



Note: Do not touch the pickup-roller pad.

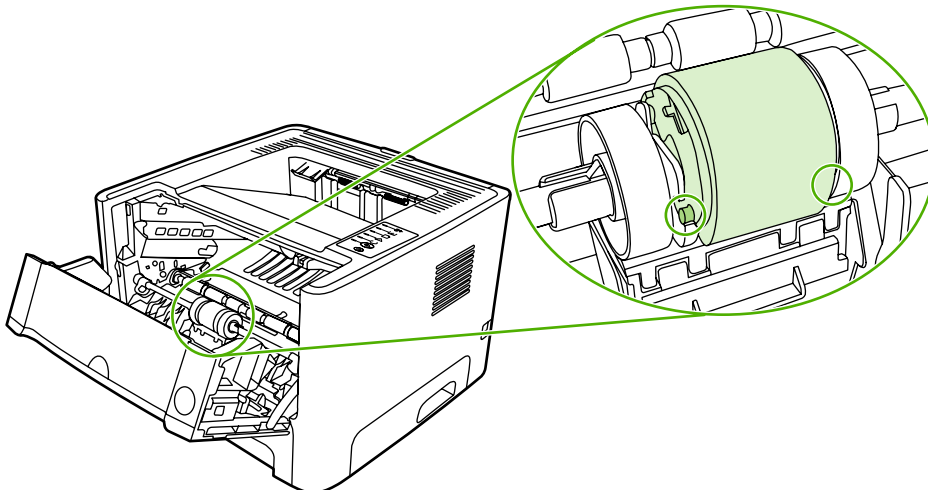

9. Grasping the pickup-roller cover with thumb and forefinger, insert the pickup-roller cover's right retaining tab into the retaining slot.

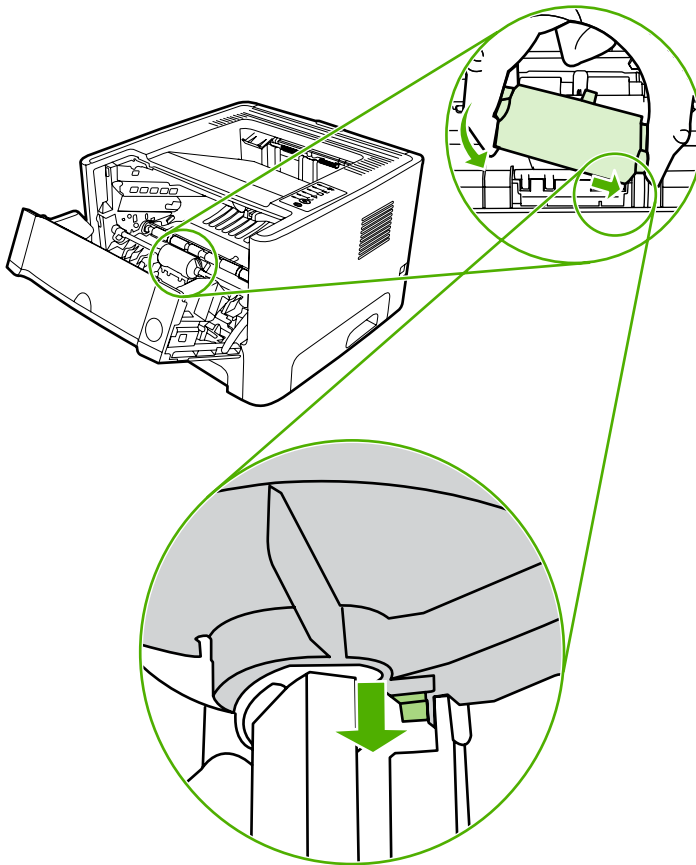

10. Squeeze the left side of the pickup-roller cover and insert the left retaining tab in the retaining slot.

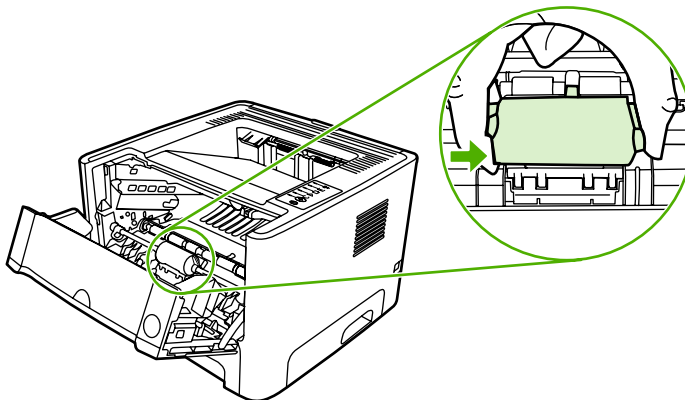

11. Close the print-cartridge door.

Replace the pickup roller (tray 2)

1. Remove tray 2.

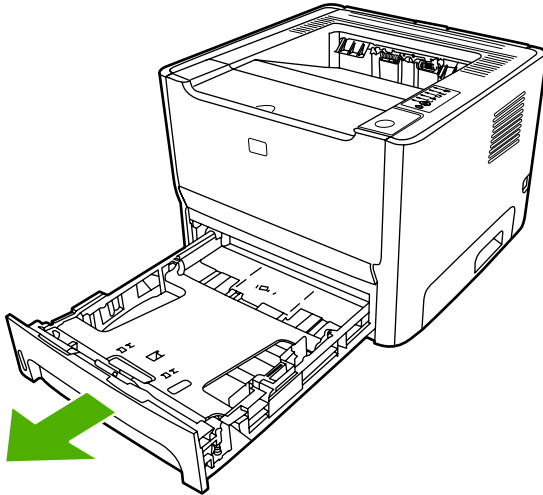

2. Open the automatic two-sided path door on the front of the printer (HP LaserJet P2015d, HP LaserJet P2015dn, and HP LaserJet P2015x printers only).

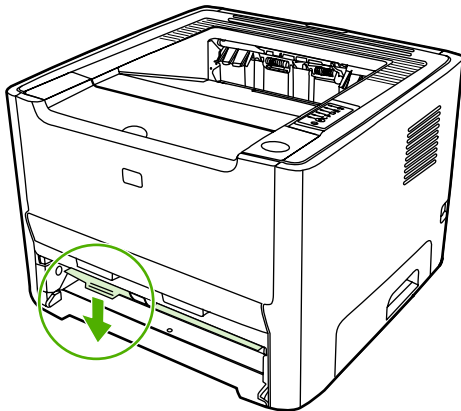

3. Place the printer on the work surface with the front of the printer facing up.

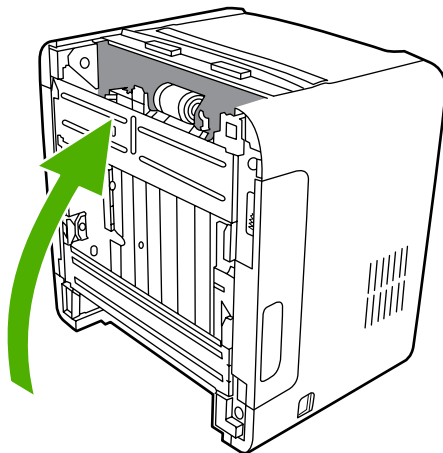

4. Pull the white tabs outward, and rotate the tabs up.

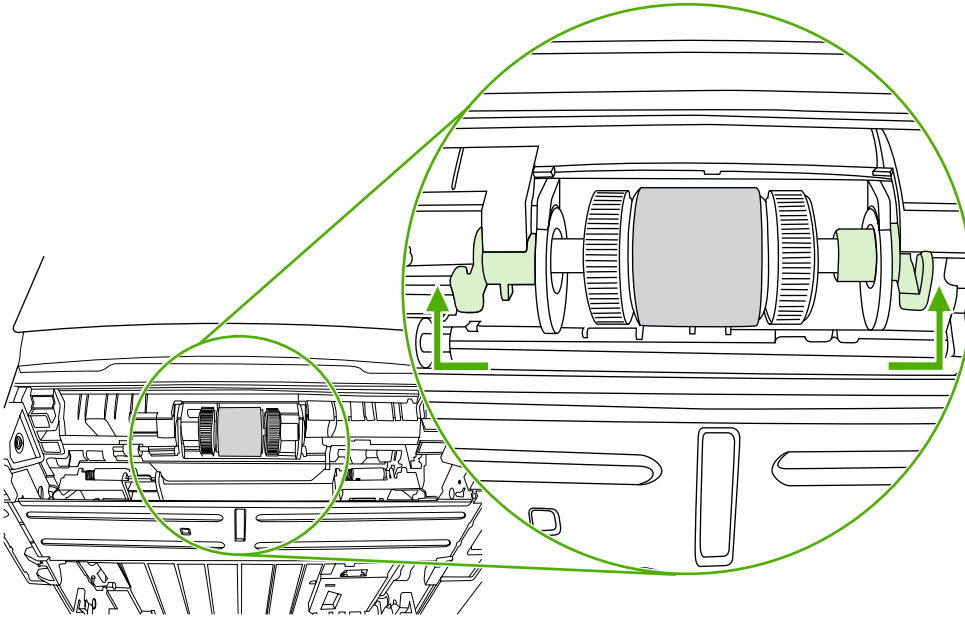

5. Slide the right tab to the right, and leave the tab in this position throughout the procedure.

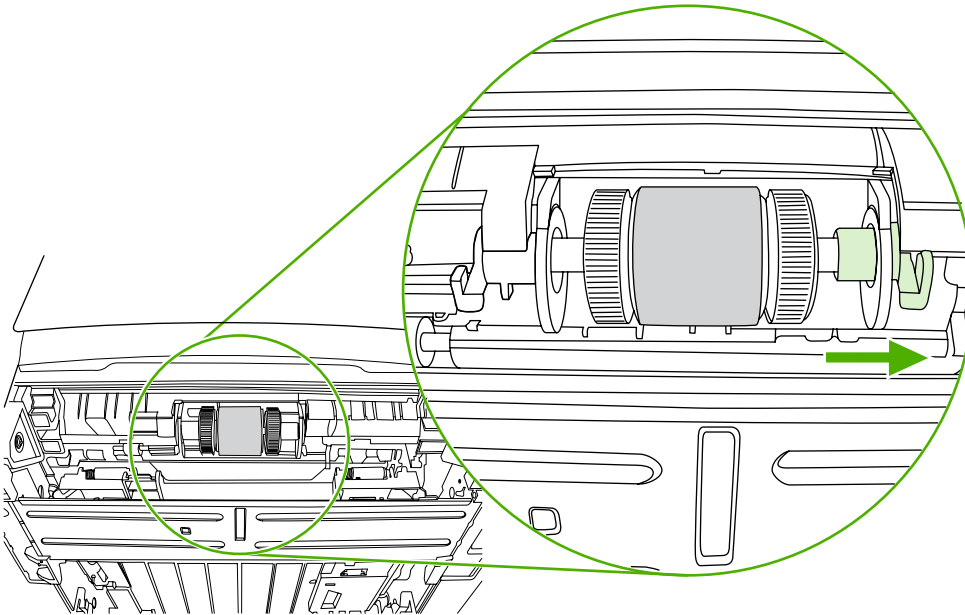

5. Slide the pickup roller assembly to the right, and remove the left end cap.

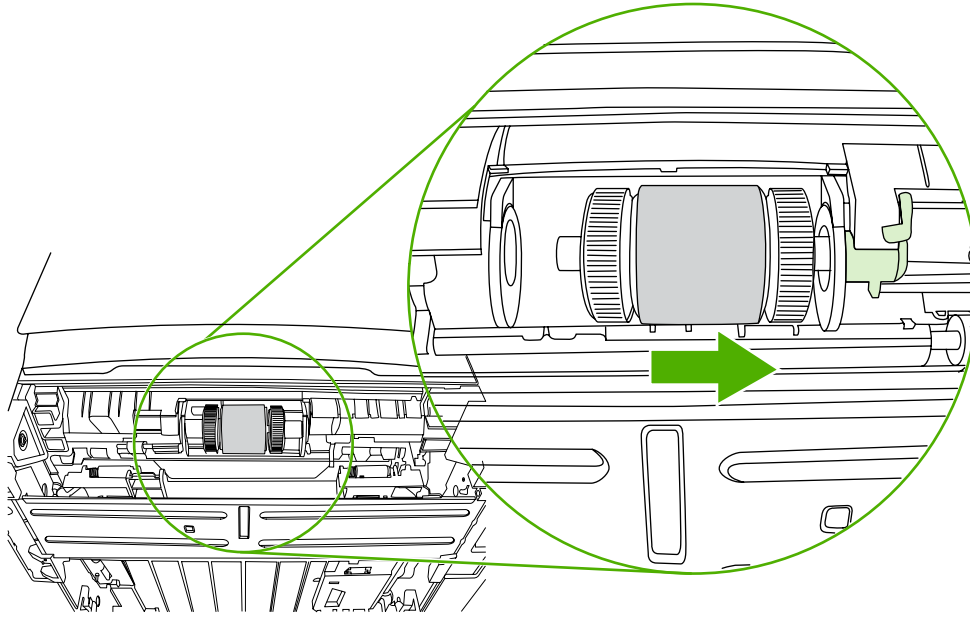

6. Remove the old pickup roller.

Note: Save both idler rollers that sit on either side of the pickup roller; transfer to new roller.

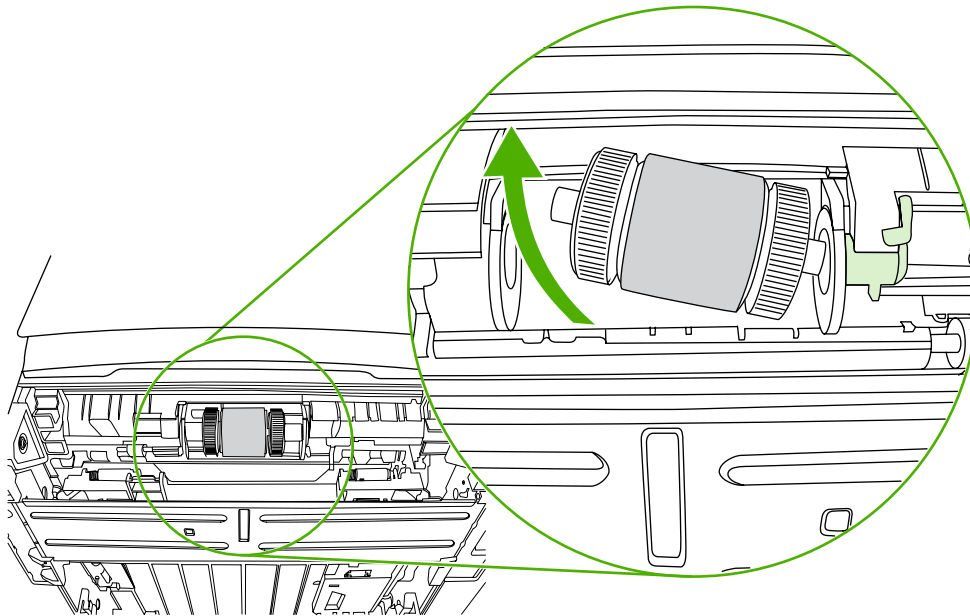

7. Insert the left side of the new pickup roller into the left slot (1), and insert the right side (the side that has the notches in the shaft) into the right slot (2).

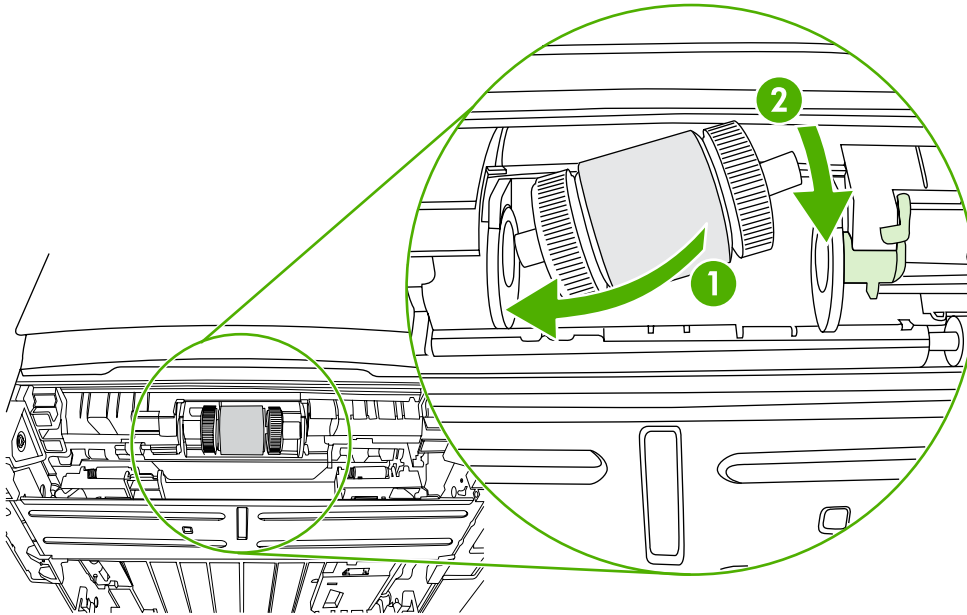

8. Place the end cap over the shaft on the left side, push the end cap to the right, and rotate the tab downward into position.

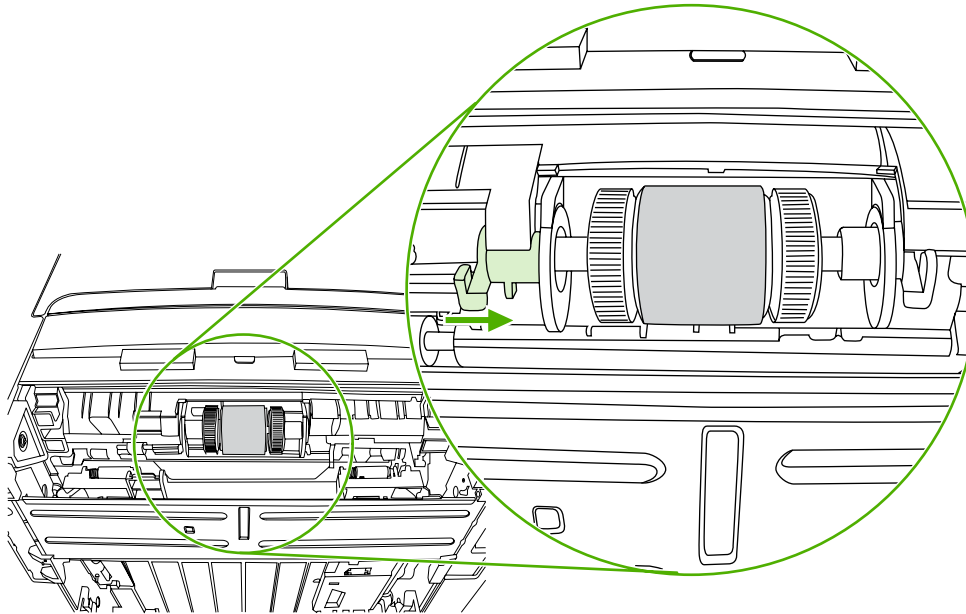

9. Rotate the shaft until the notches engage and the shaft clicks into place.
10. Push the right tab to the left, and rotate the tab downward into position.

Tray 2 Separation Pad

1. Remove the cassette paper tray (tray 2) from the printer.
2. Remove the 2 screws (circled in picture below) which secure the separation pad.

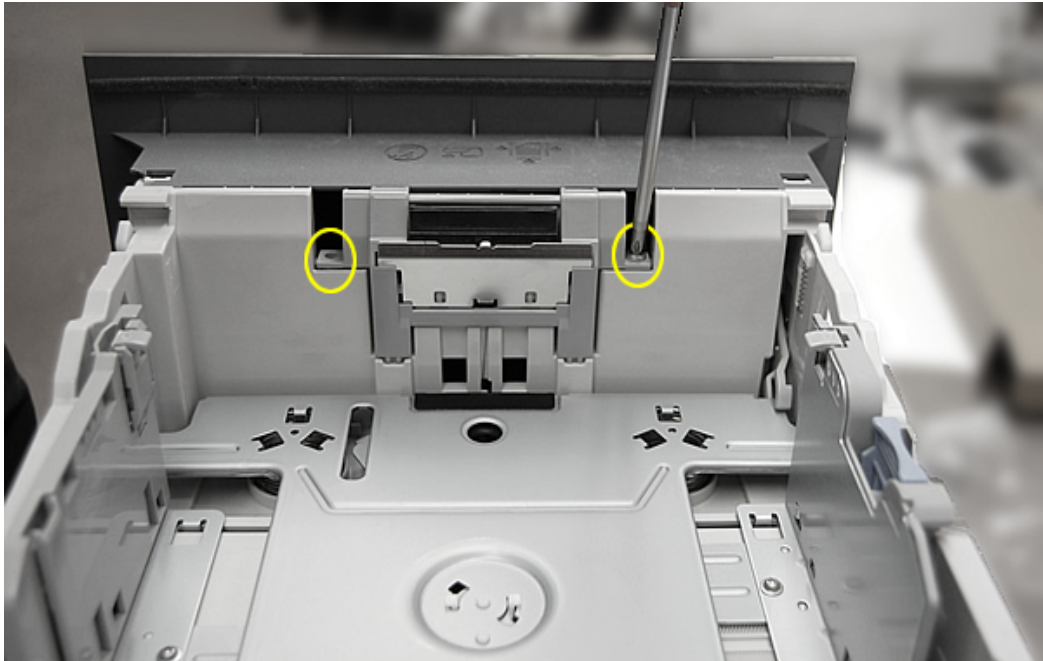

3. Remove the old separation pad assembly. Insert the new assembly and replace the screws.



Covers

Left-side cover

1. Open the print-cartridge door.
2. At the back of the printer, use a flat-blade screwdriver to release two tabs (1).

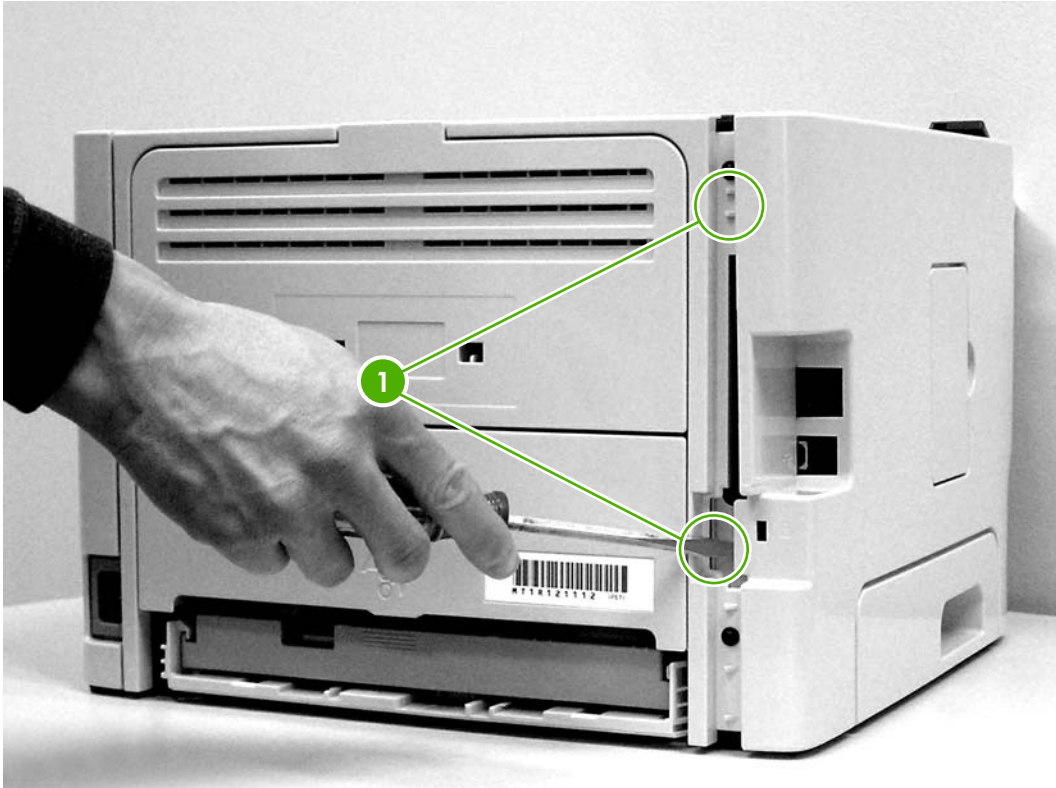

Figure 6-1 Removing the left-side cover (1 of 2)

3. Lift the cover away from the printer.

Right-side cover

1. Open the print-cartridge door.
2. Remove tray 2.

3. At the front of the printer, pop the front edge of the right-side cover over the two retaining tabs.



Figure 6-2 Removing the right-side cover

4. Lift the cover away from the printer.

Back cover

1. Remove tray 2.
2. Remove the left-side cover and the right-side cover.

3. Remove four screws (1).

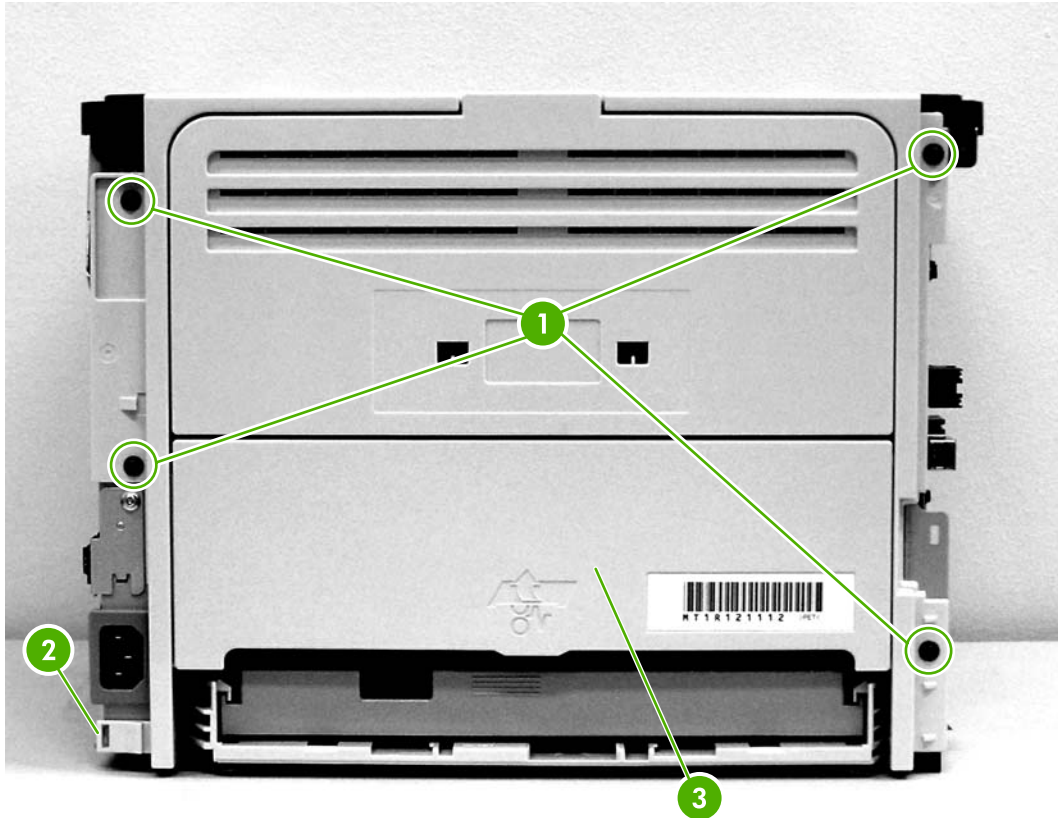

Figure 6-3 Removing the back cover (1 of 2)

4. Tip the printer so that it rests on its front.
5. Release the tab (2) at the back of the printer on the right side.
6. Open the duplex access door (3).

7. Slide the cover toward the right side of the printer to clear the tab (1) on the duplexer tray (duplex models only).

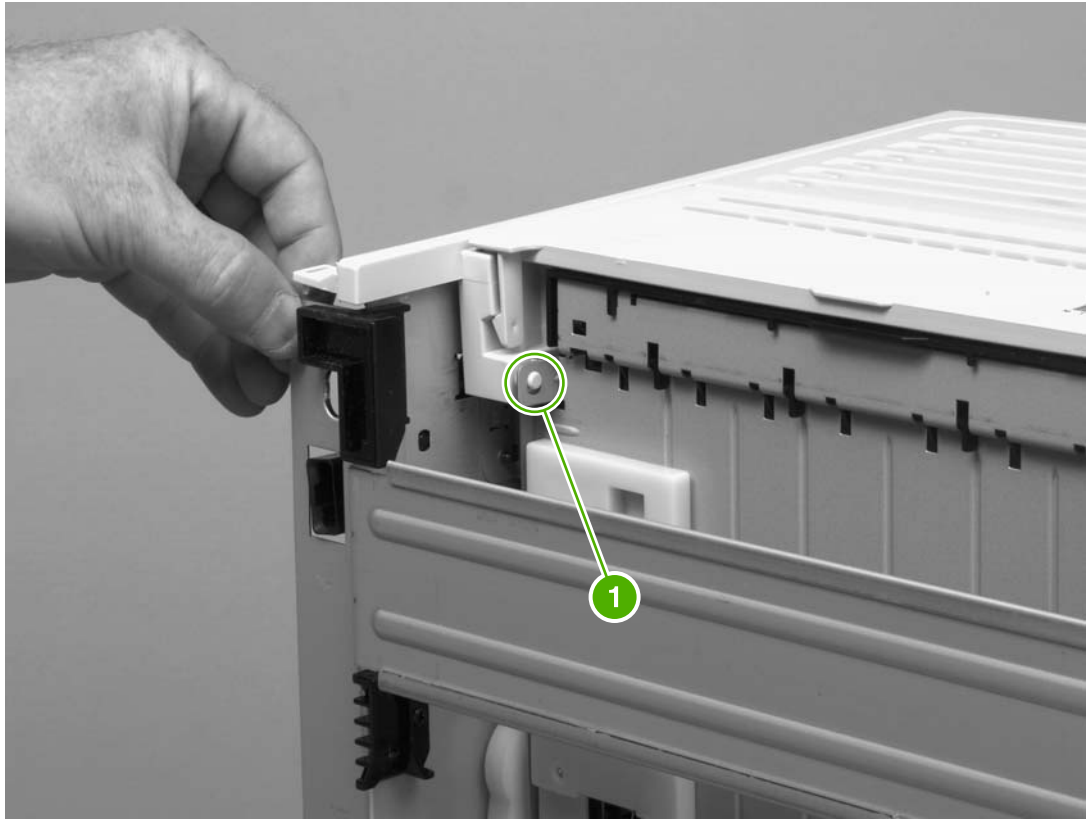

Figure 6-4 Removing the back cover (2 of 2)

8. Lift the cover straight up and away from the printer.

Duplexer tray (HP LaserJet P2015d, P2015dn, and P2015x printers only)

1. Remove the left-side cover, the right-side cover, and the back cover.

2. Pull the duplexer tray release-tab (1) to release the duplexer tray magnets.

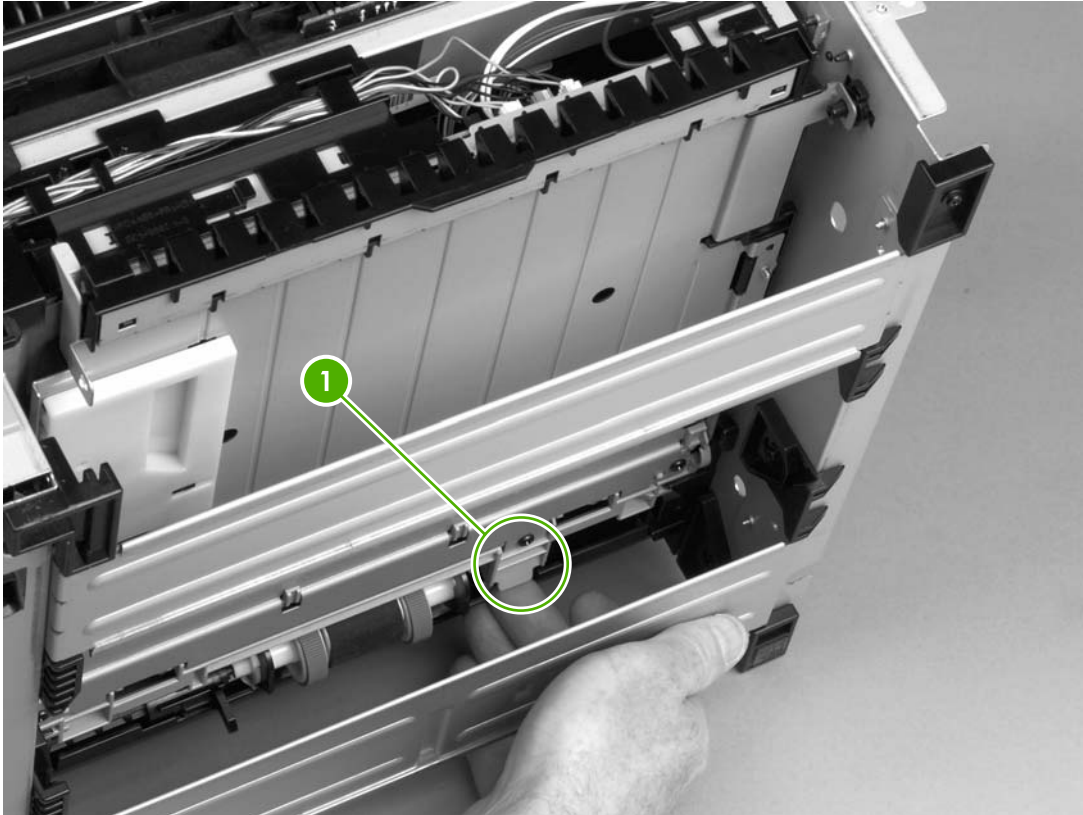

Figure 6-5 Removing the duplexer tray

3. Pull out the duplexer tray.

Top cover

1. Remove the left-side cover, the right-side cover, the back cover, and the duplexer tray.

2. Remove two screws (1) at the back of the printer.

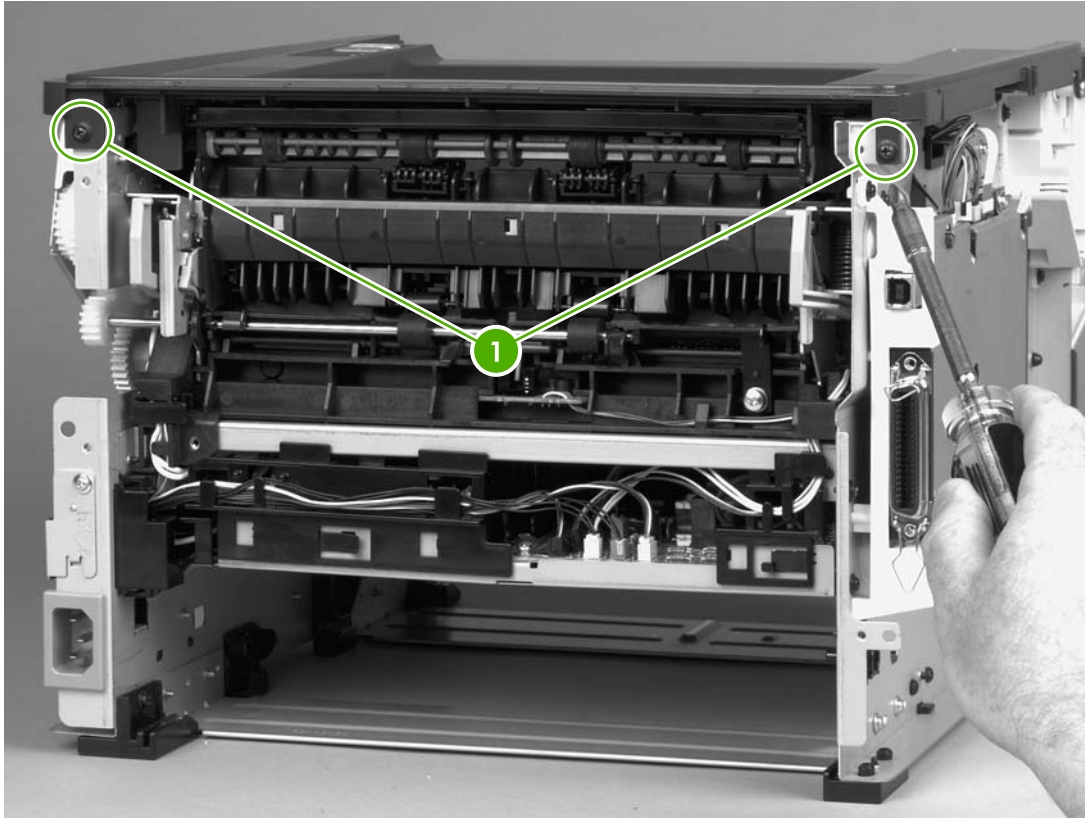

Figure 6-6 Removing the top cover (1 of 4)

3. Remove one screw (1) on the left side of the printer, and remove one screw (2) on the right side of the printer.

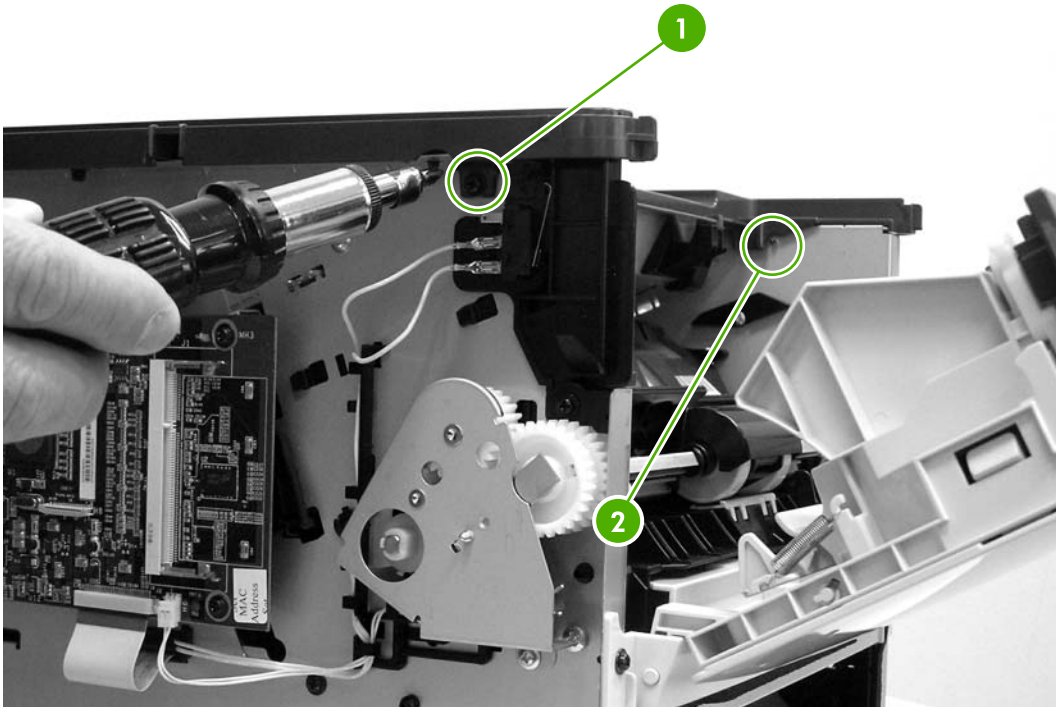

Figure 6-7 Removing the top cover (2 of 4)

4. Release the control-panel cable (1) on the left side of the printer.

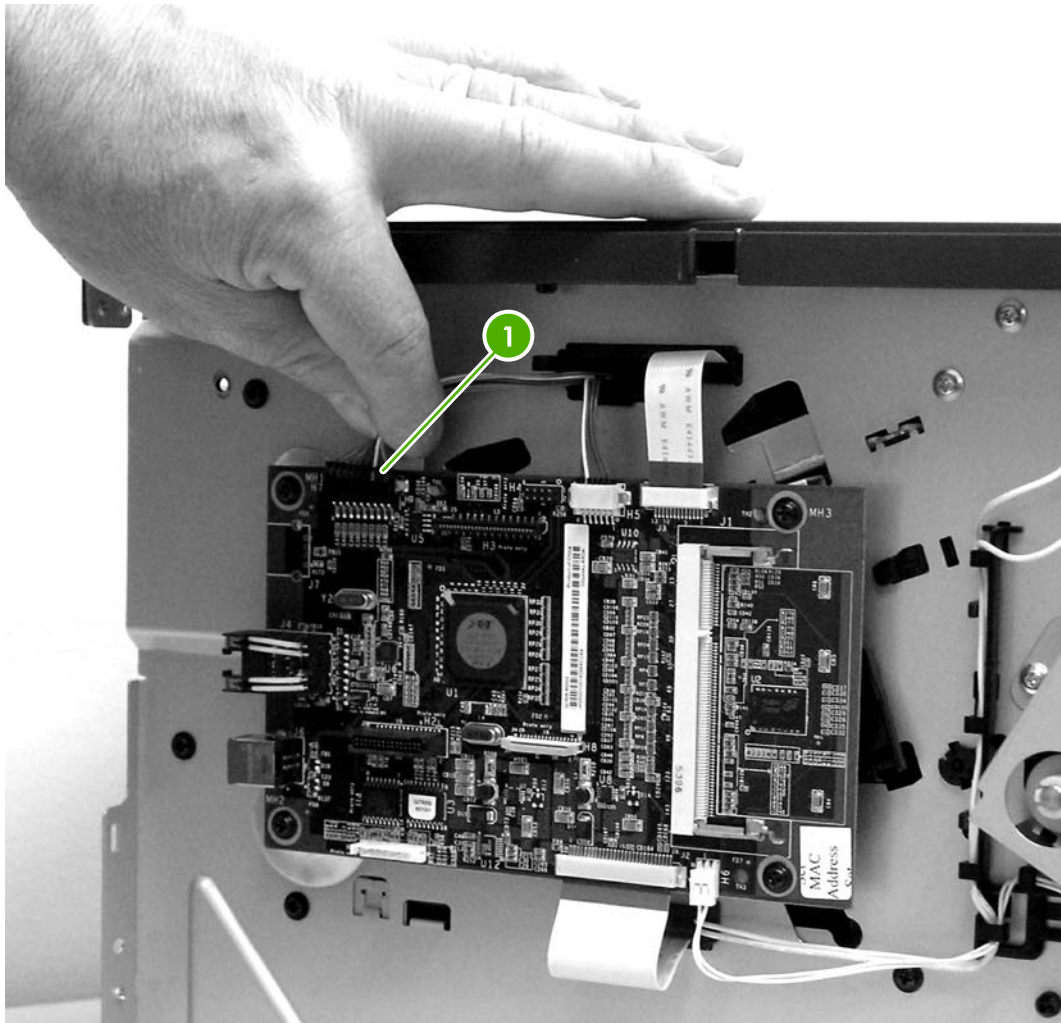

Figure 6-8 Removing the top cover (3 of 4)

5. Lift the top cover off the printer.

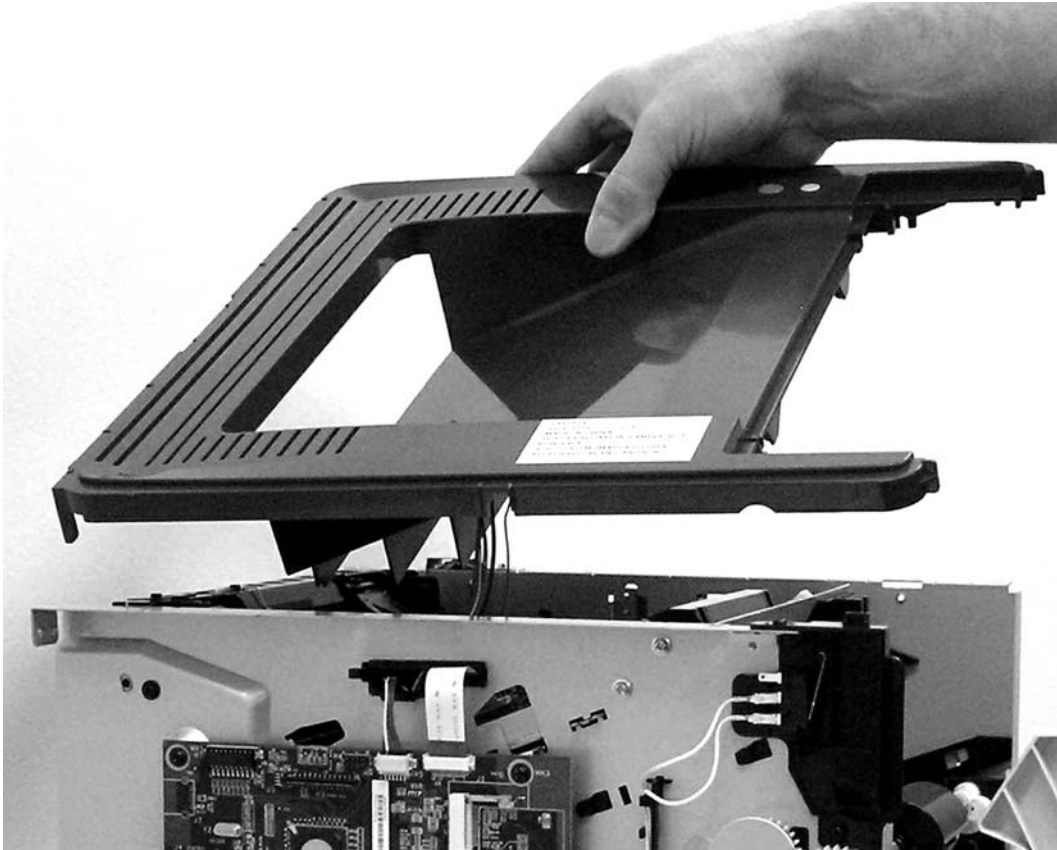

Figure 6-9 Removing the top cover (4 of 4)

Fuser

Several parts must be removed before you can remove the fuser. The following parts are included in this section about removing the fuser:

- Fan
- Duplex-drive gears/face-down gears
- Duplex solenoid
- Fuser

Fan

1. Remove all covers.
2. Disconnect the fan cable (1) at the ECU.

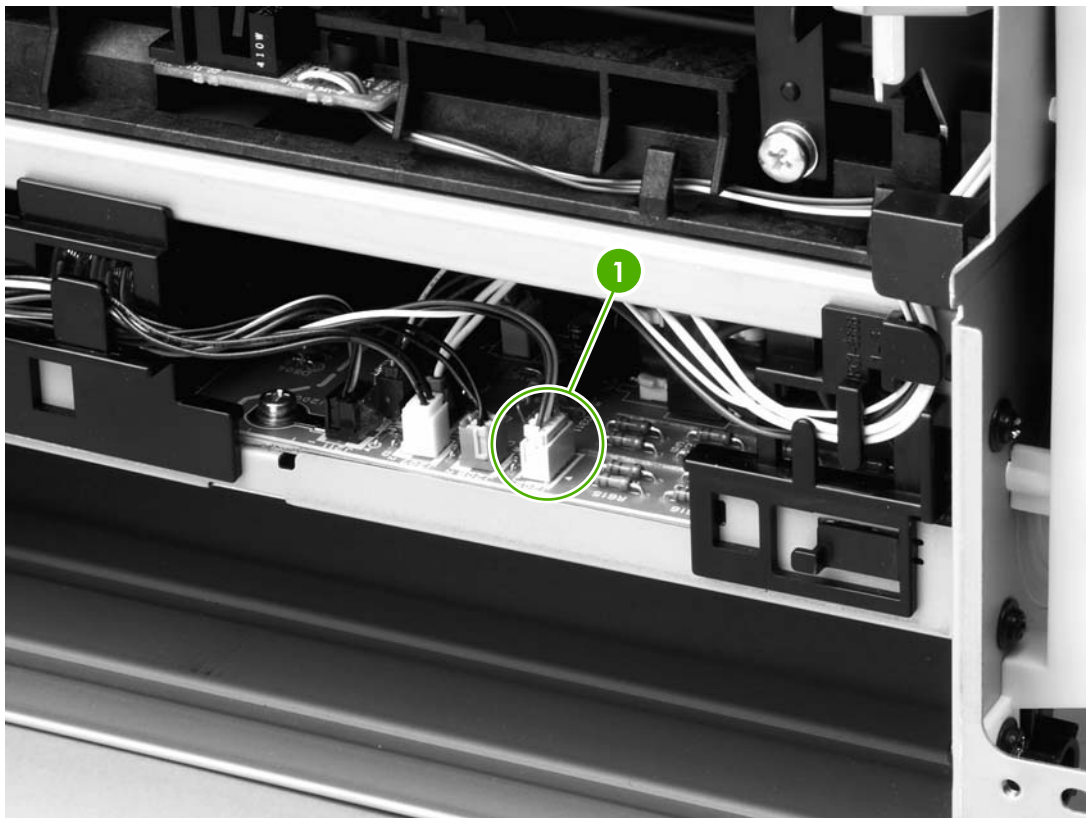

Figure 6-18 Removing the fan (1 of 2)

3. Unthread the fan wires from the retaining clips.
4. Remove two screws (1).

5. Unhook the fan clip (2) and then lift the fan off the printer.

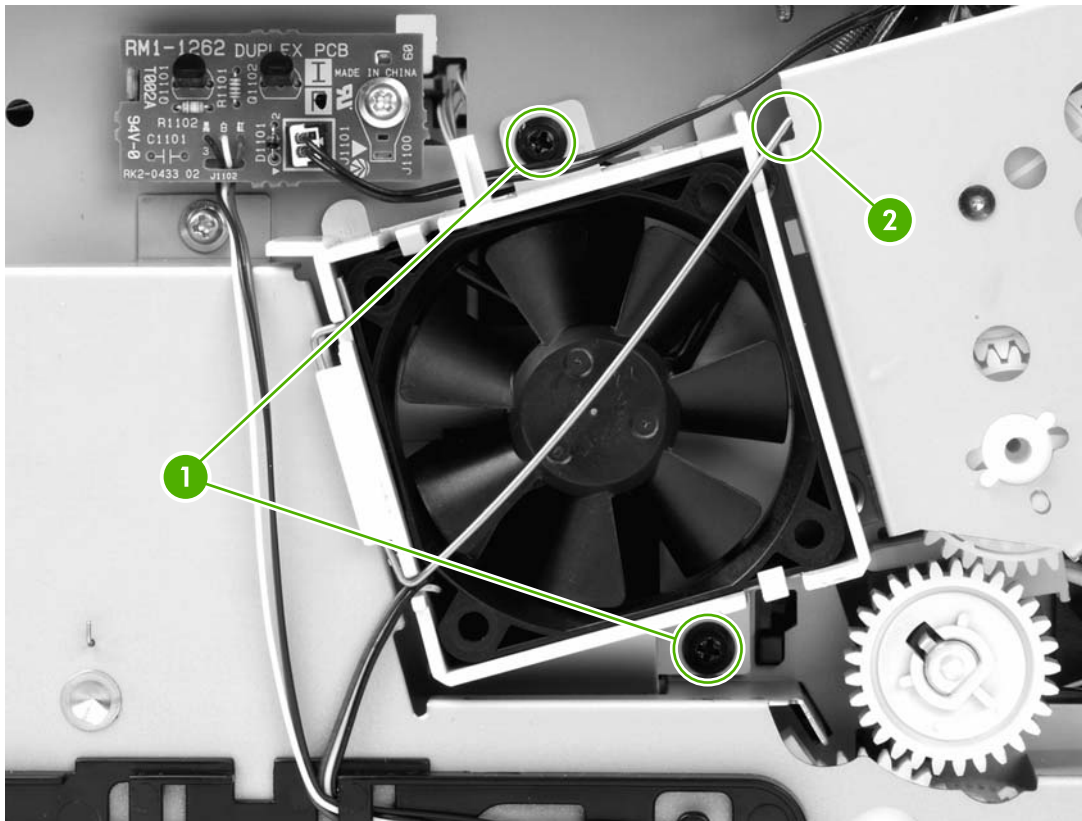

Figure 6-19 Removing the fan (2 of 2)

Duplex-drive gears (HP LaserJet P2015d, P2015dn, and P2015x printers only)

1. Remove all covers.
2. Remove the fan.
3. Remove three screws (1).

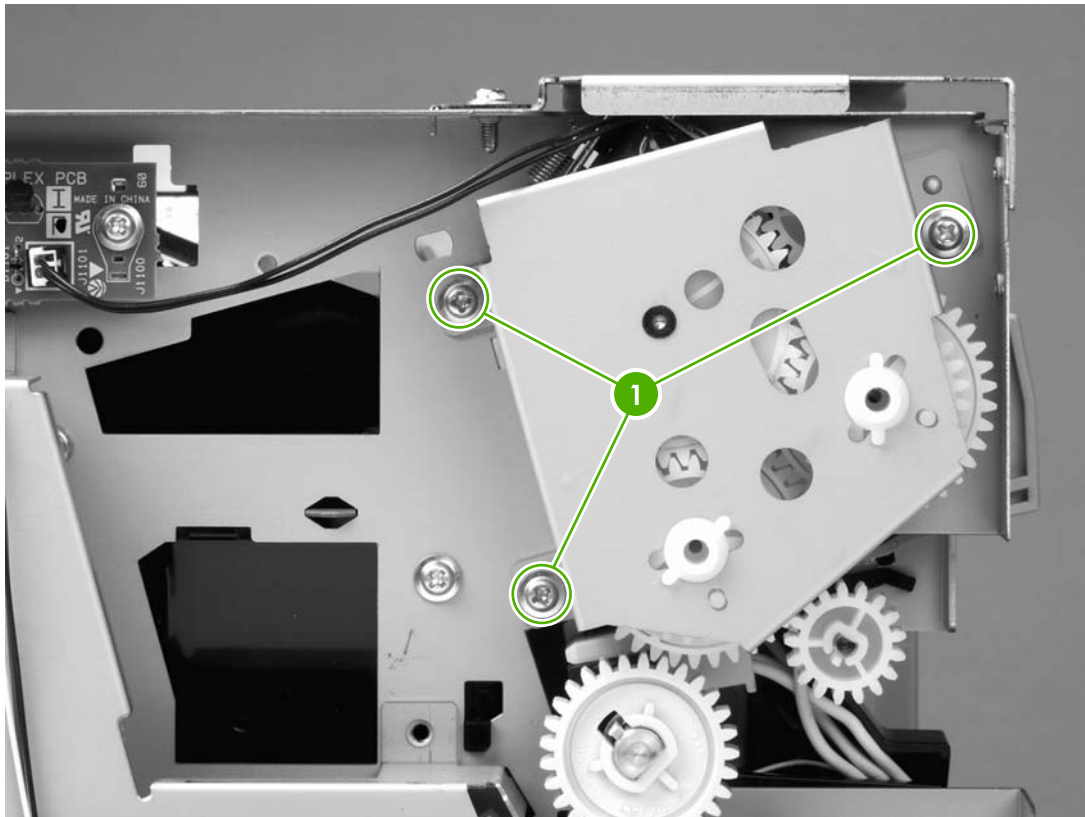

Figure 6-20 Removing the duplex-drive gears (1 of 2)

4. Lift the assembly away from the printer.

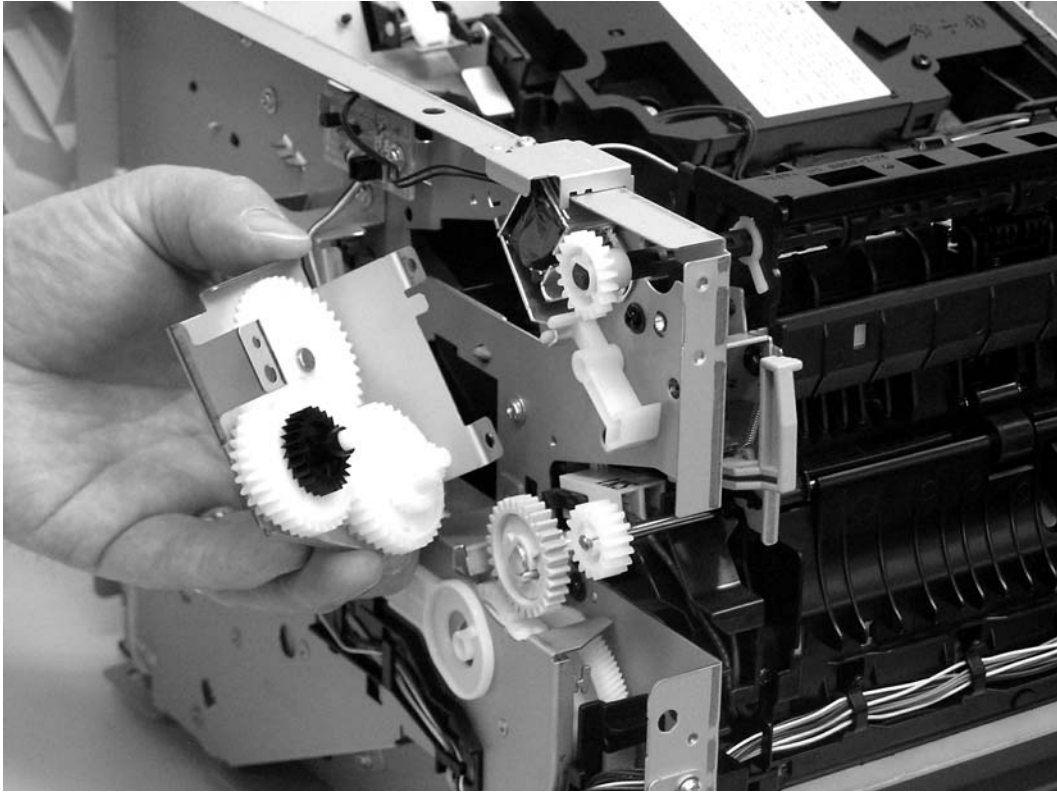

Figure 6-21 Removing the duplex-drive gears (2 of 2)



NOTE The gears are not attached to the gear plate. Carefully remove the gear plate and the gears together to prevent them from falling out of the assembly.

Duplex solenoid (HP LaserJet P2015d, P2015dn, and P2015x printers only)

1. Remove all covers.
2. Remove the fan.
3. Remove the duplex-drive gears.
4. Disconnect one cable (1) at the duplex-drive PCA.
5. Remove one screw (2), and then lift the solenoid off the printer chassis.

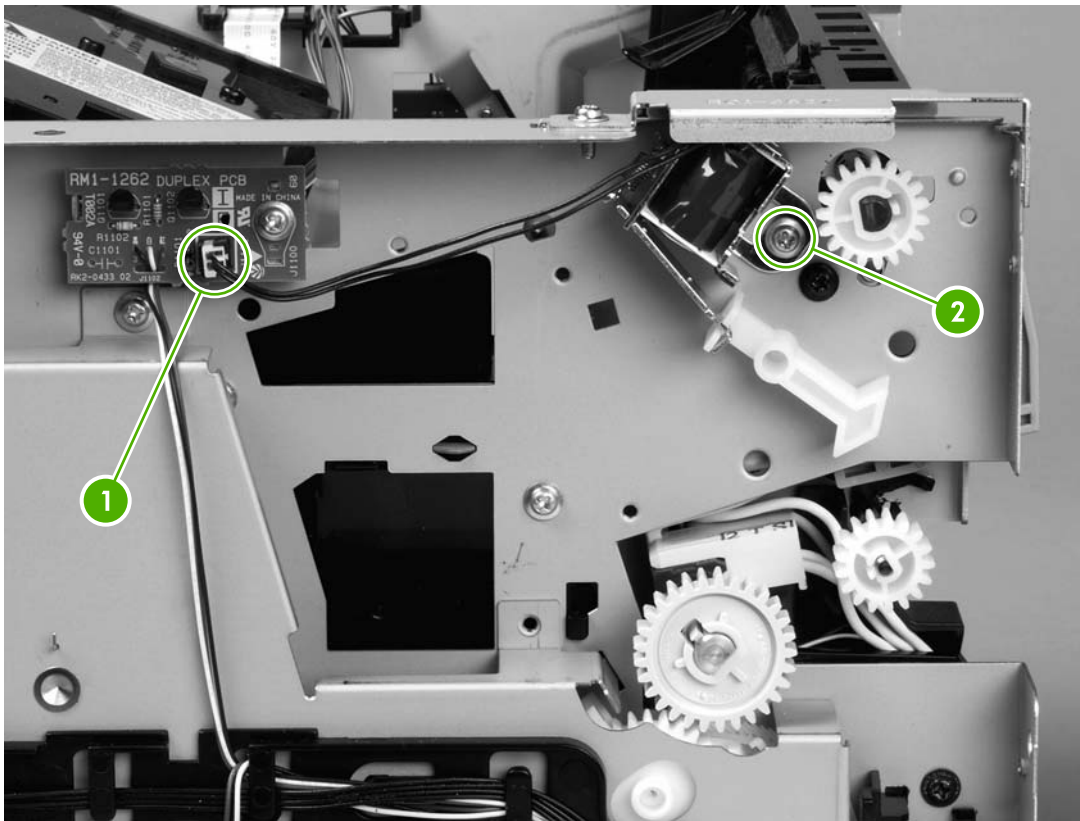

Figure 6-22 Removing the duplex solenoid

Fuser

1. Remove all covers.
2. Remove the fan.
3. Remove the duplex-drive gears or face-down gears.
4. Remove the formatter.
5. On the right side of the printer, press the tabs on two gears (1) to release the gears, and then slide the gears off the shafts.
6. Disconnect one cable (2) on the right side of the printer.

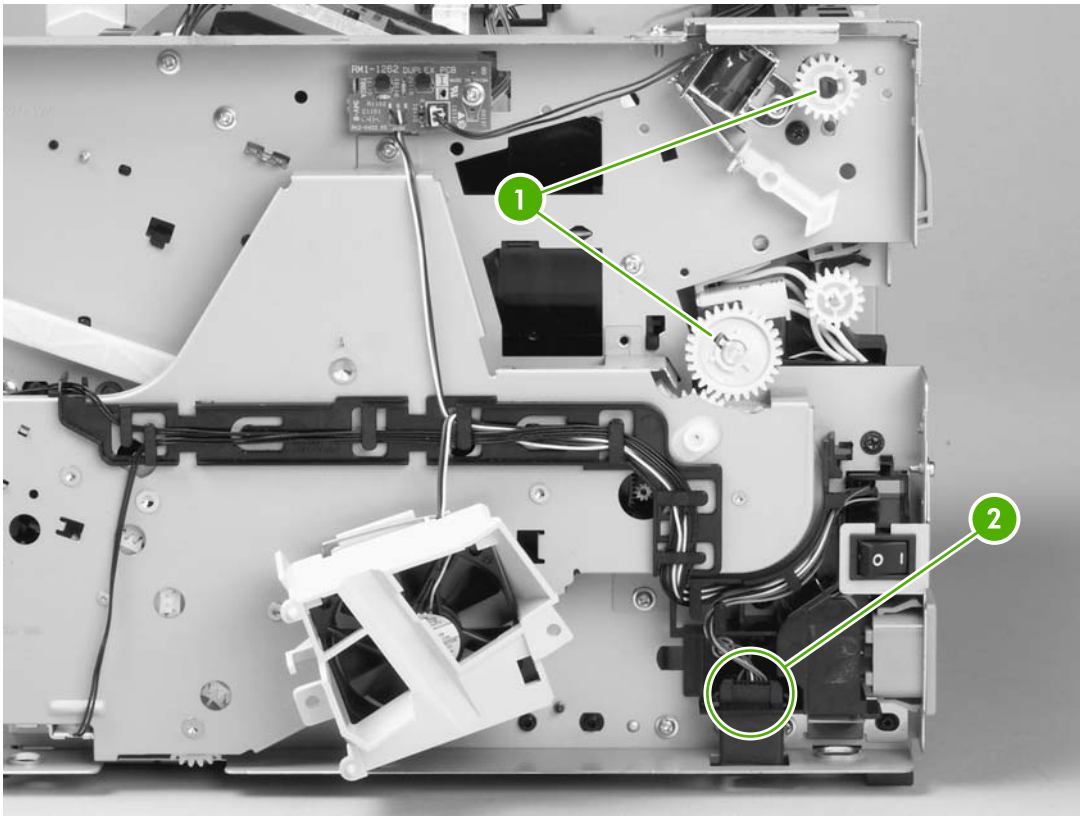

Figure 6-23 Removing the fuser (1 of 10)

7. Disconnect four cables (1) from the ECU, and then disconnect two more cables (2) that were behind the first set.

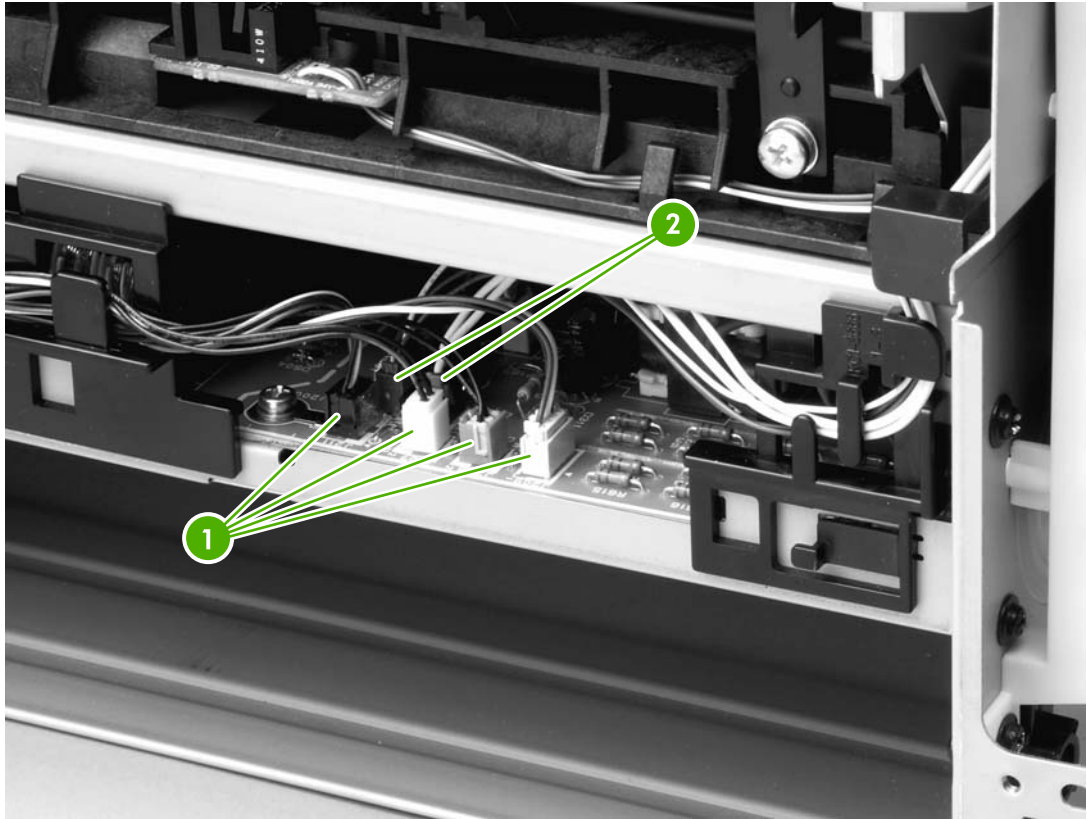

Figure 6-24 Removing the fuser (2 of 10)

8. Pull the tab on the cable holder (1) at the left side of the printer and slide it toward the center to release it from the frame, and then unroute the cables.

9. Pull the tab on the cable holder (2) and slide it toward the center to release it from the frame, and then unroute the cables.

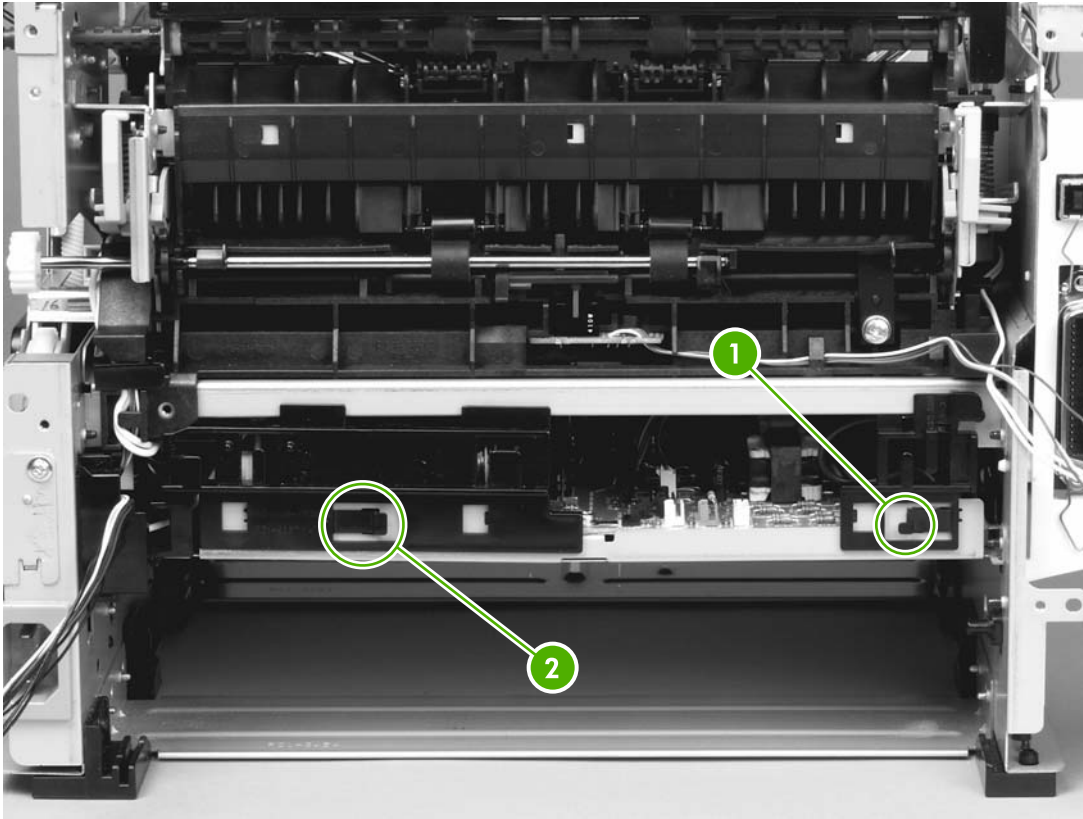

Figure 6-25 Removing the fuser (3 of 10)

10. Remove one screw (1) from the fuser cover, and then slide the fuser cover to the right and remove it.

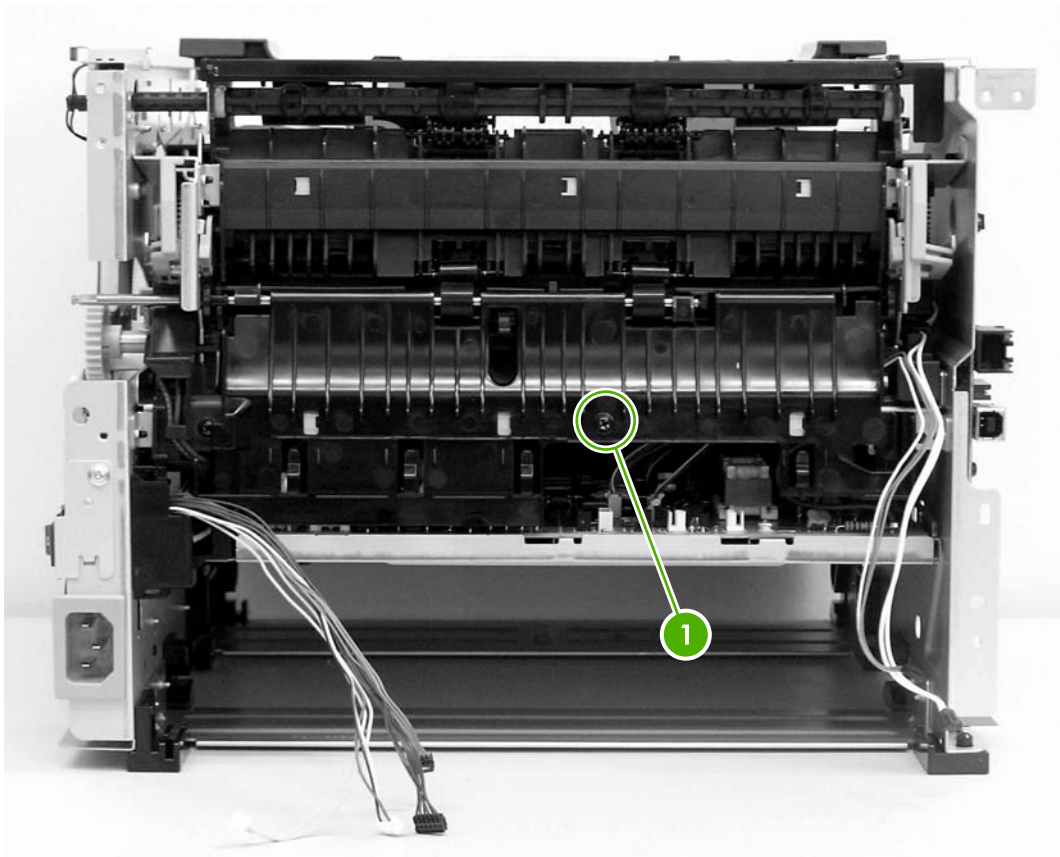

Figure 6-26 Removing the fuser (4 of 10)

11. Disconnect three cables (1).

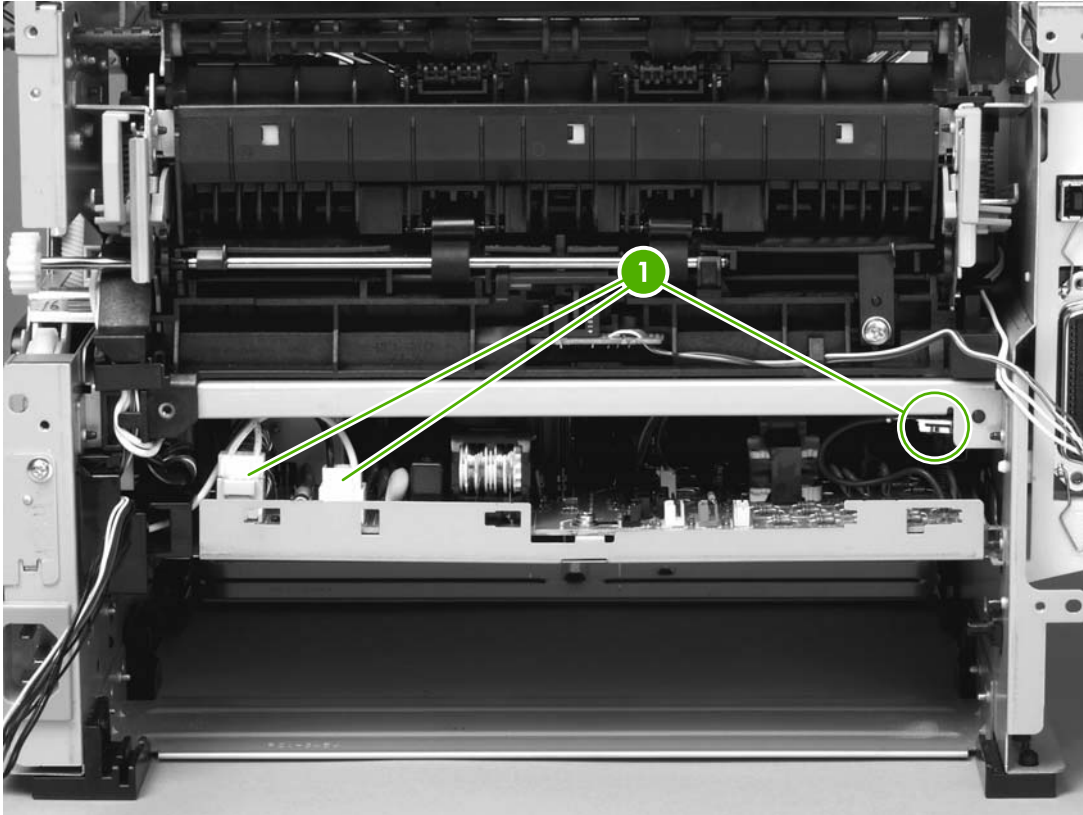

Figure 6-27 Removing the fuser (5 of 10)

12. Disconnect one cable (1), and then unroute the cable from the cable guide.

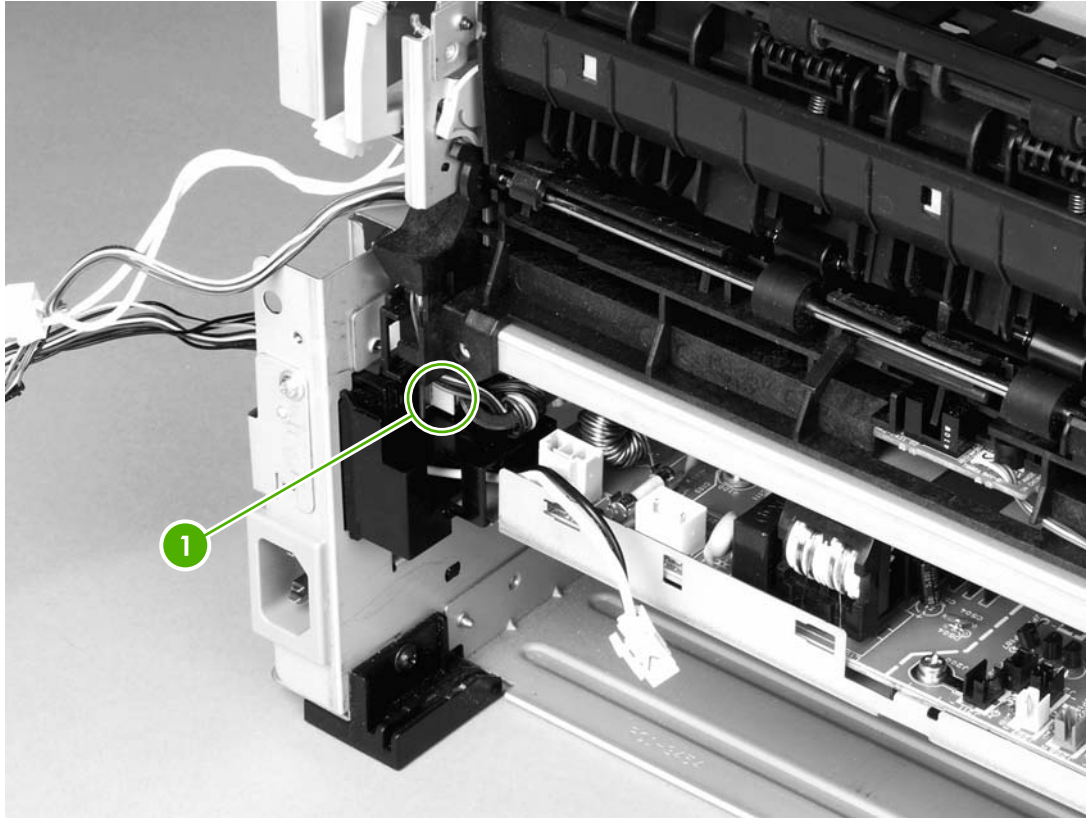

Figure 6-28 Removing the fuser (6 of 10)



NOTE Before you proceed to step 13, make sure that all cables disconnected in previous steps are free from any cable guides and cable holders.

13. Remove three screws (1) on the right side of the printer.

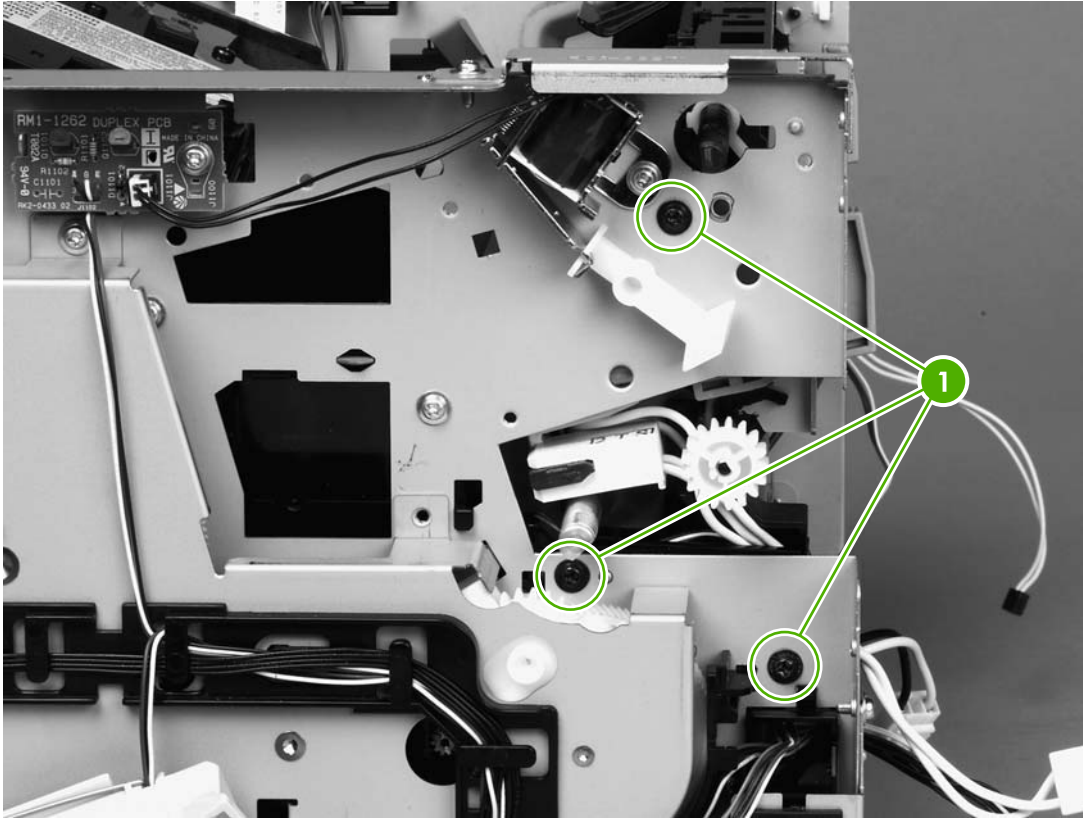

Figure 6-29 Removing the fuser (7 of 10)

14. Remove three screws (1) from the left side of the printer.

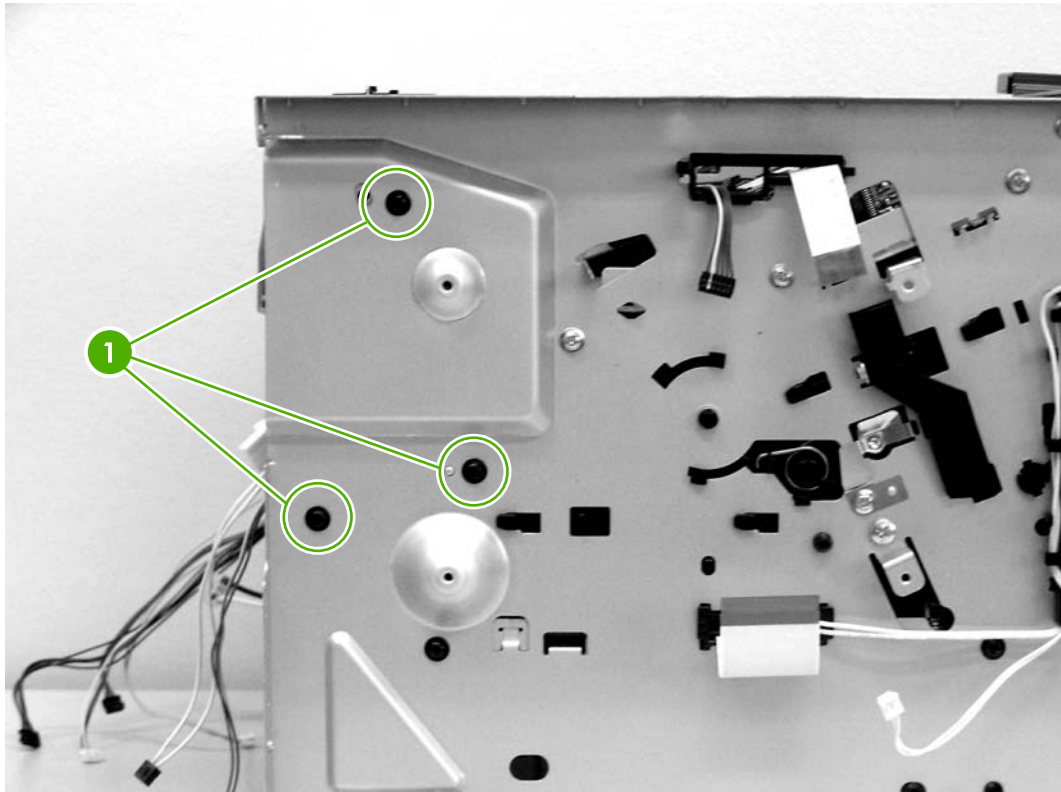

Figure 6-30 Removing the fuser (8 of 10)

15. At the left side of the printer, pull the printer chassis from the top to spread the printer frame and release the fuser from the frame.

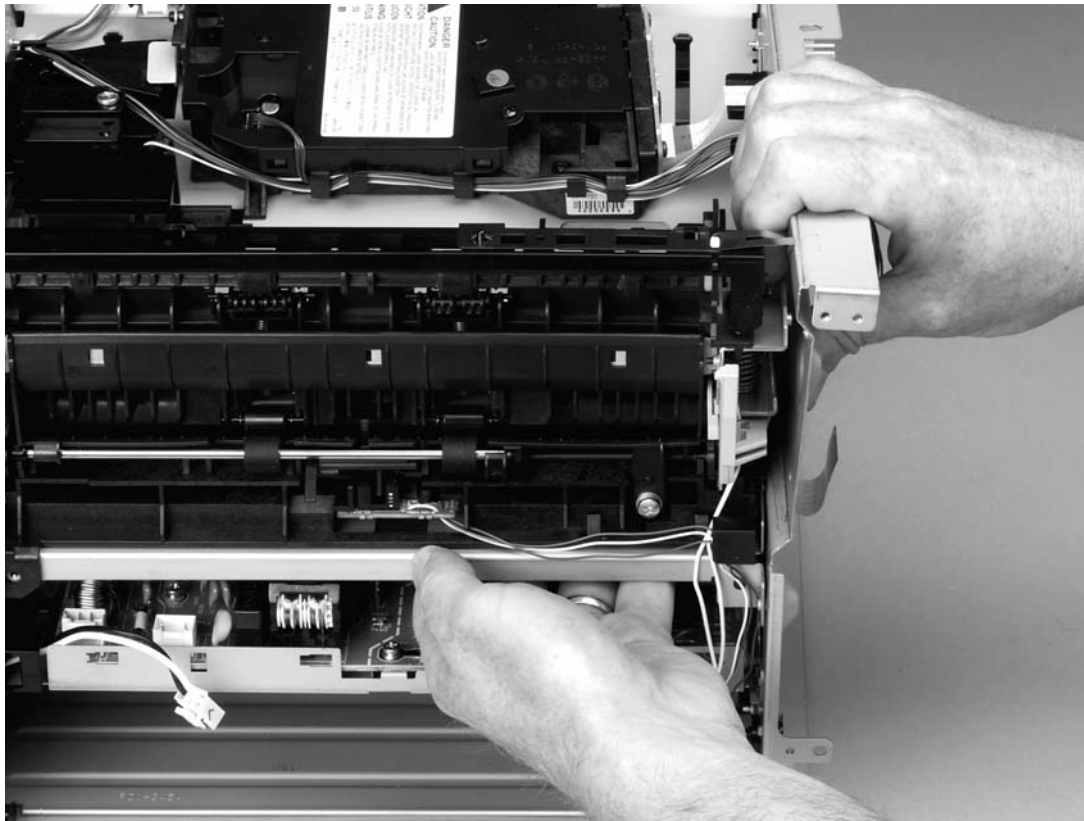

Figure 6-31 Removing the fuser (9 of 10)

16. Pull the fuser out of the printer at an angle so that the delivery roller shaft clears the hole (1) in the chassis.

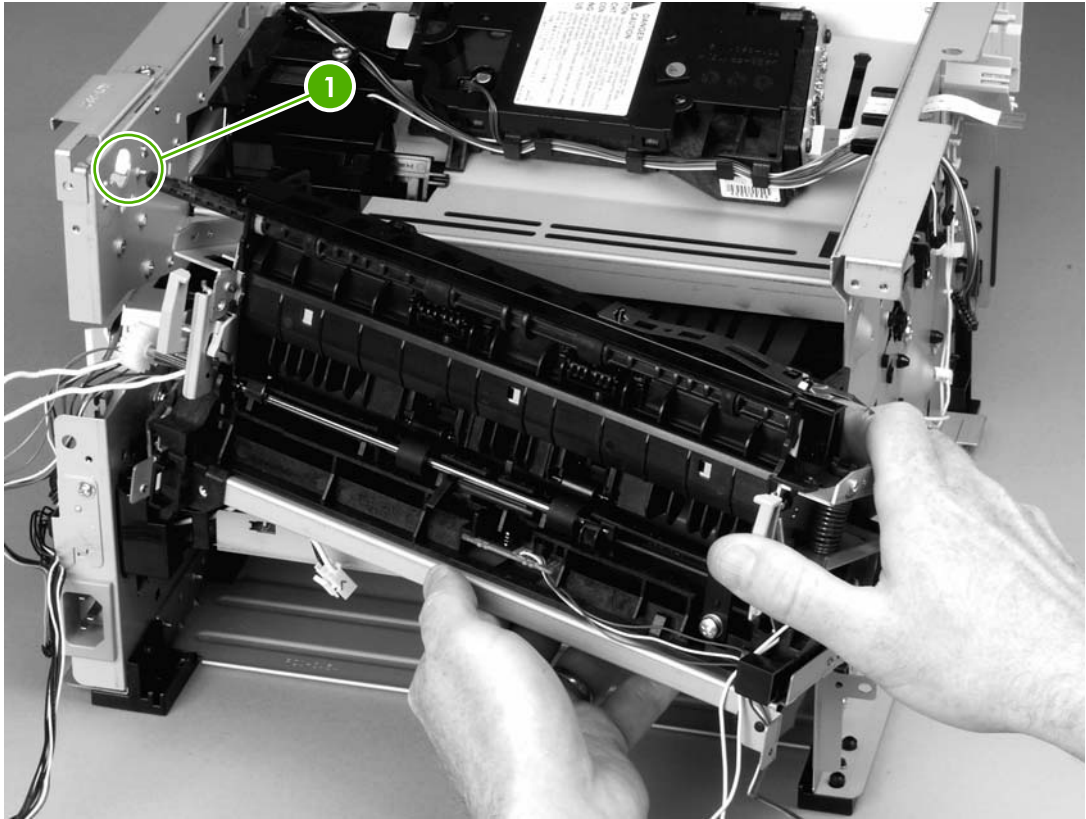

Figure 6-32 Removing the fuser (10 of 10)