

Maintenance Kit Instructions

HP Color LaserJet 2820, 2840 Series



Replacing the fuser assembly

- 1 Turn off the device, and then disconnect the power cable.
- 2 Rotate the locks on the fuser assembly to the unlocked position.

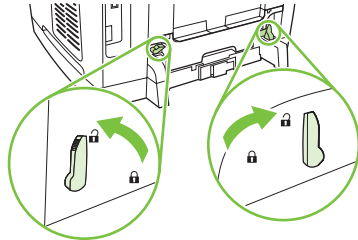

- 3 Grasp the fuser handle and pull the fuser assembly from the device.

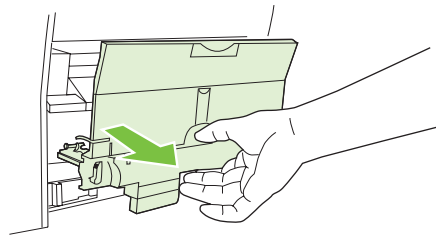

CAUTION The parts on the internal surface of the fuser assembly are very hot. To avoid burning yourself, do not touch those parts.

- 4 Insert the new fuser assembly into the device.

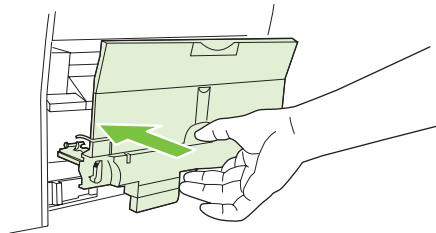

- 5 Rotate the locks on the fuser assembly to the locked position.

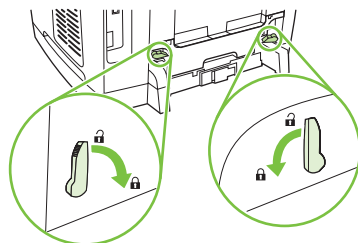

Replacing the tray 1 pickup roller and separation pad

- 1 Turn the device off and disconnect the power cable from the back of the device.

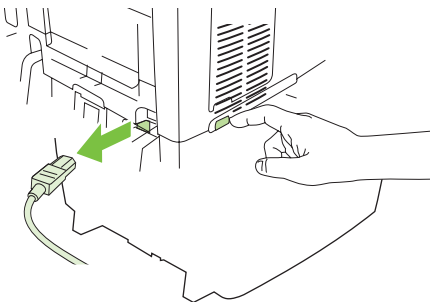

- 2 Open tray 1.

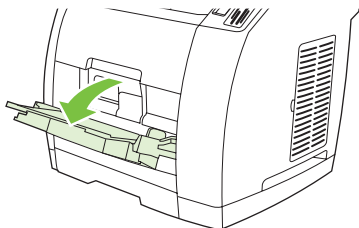

- 3 Find the multipurpose roller cover that is located beneath the pickup roller in tray 1.

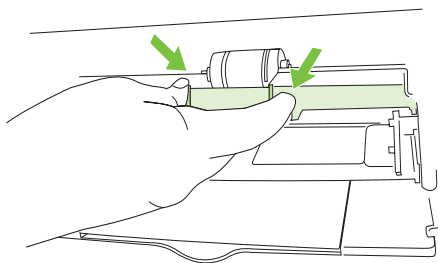

- 4 Grasp both sides of the center tab and pull the cover out of the device.

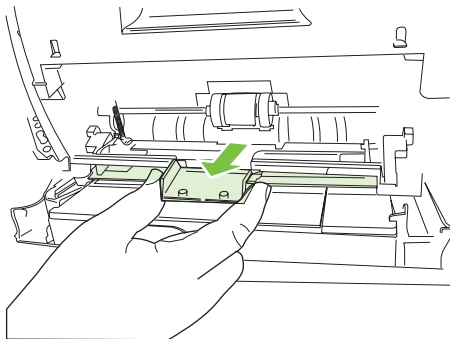

- 5 Squeeze the tab on the idler roller that is located on the right side of the pickup roller. If the tab is not visible, rotate the idler roller so that the tab is toward the front of the device.

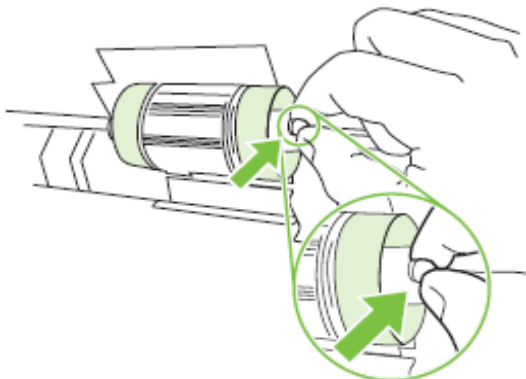

- 6 Slide the idler roller to the right to separate it from the pickup roller.

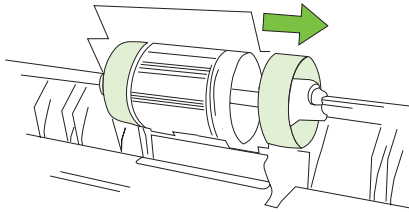

- 7 Squeeze the tab on the idler roller that is located on the left side of the pickup roller. If the tab is not visible, rotate the idler roller so that the tab is toward the front of the device.

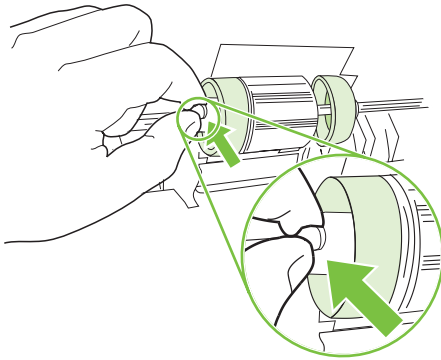

- 8 Slide the idler roller to the left to separate it from the pickup roller.

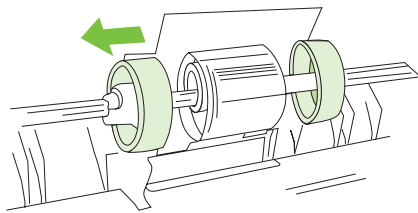

- 9 Press and hold the button that is located on the right side of the pickup roller. Slide the pickup roller slightly to the right, and then pull it off of the shaft.

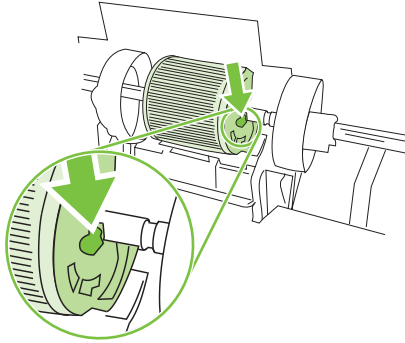

- 10 Move the remaining roller cam to the right so that it no longer sits above the separation pad.

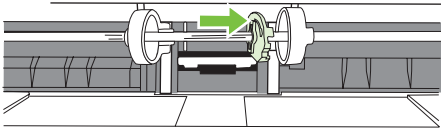

Moving the roller cam will reveal a pin in the roller shaft. Do not remove the pin.

- 11 Locate the separation pad beneath the area of the shaft from which the pickup roller was removed.

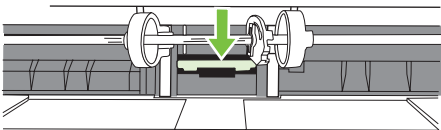

- 12 Insert a flatblade screwdriver into the slot under the separation pad. Pry the pad up from the spring-loaded base by twisting the screwdriver until the tabs are separated from the device.

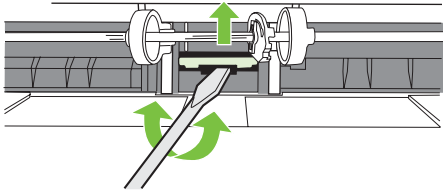

- 13 Use one hand to push the spring-loaded base down and then use the other hand to pull the separation pad up and out of the device.

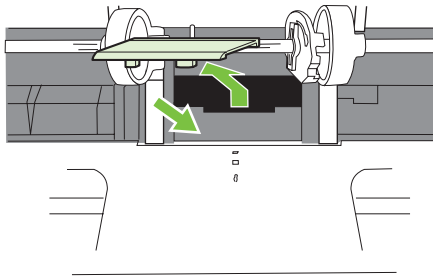

NOTE If you feel resistance when you try to remove the pad, make sure that the tabs are completely separated from the device.

- 14 Push the spring-loaded base down and position the new separation pad in the empty slot.

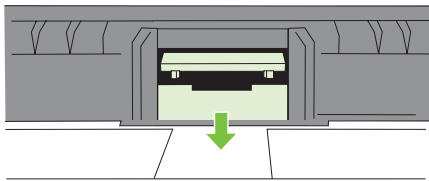

NOTE Make sure that the two tabs on the edge of the pad are toward the front of the device.

- 15 Snap both sides of the separation pad firmly into place until they click.

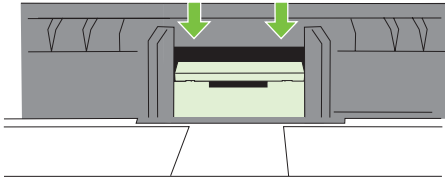

CAUTION If the pad is not straight, or if space exists between the pad and the base, make sure that the tabs on the pad are toward the front of the device.

- 16 Hold down the new separation pad, and slide the roller cam back to the left until it snaps in place with the pin. Position the new pickup roller so that the button is on the right side, and the open side of the roller faces down. Make sure that the small ridge on the open side of the roller aligns with the groove in the shaft.

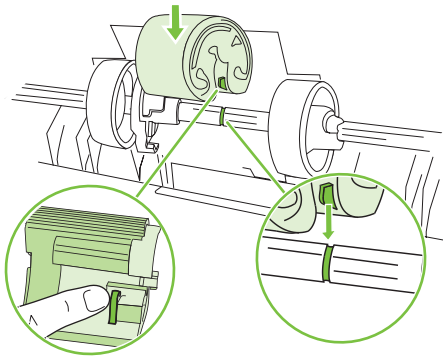

- 17 Slide the left and right idler rollers inward, against the pickup roller, until the idler rollers click into place.

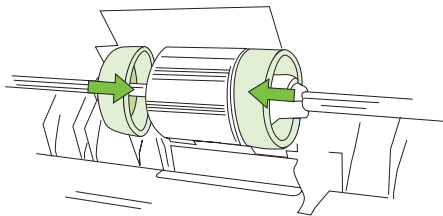

- 18** Hold the faceplate cover as shown in the illustration, and align the cover with the rails on the inside of the device.

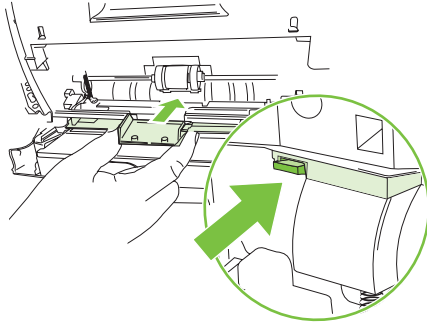

- 19** Grasp both sides of the center tab and insert the cover into the device until the cover clicks into place. Close tray 1.

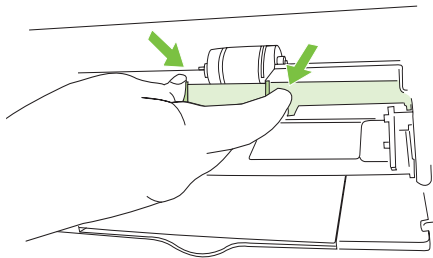

Covers

Removing the left cover

- 1 Remove the screw (callout 1) from the lower edge of the cover.



Figure 5-20 Left cover screw

- 2 Open top cover, and then disengage the latch at the front of the left cover by prying it away from the front.

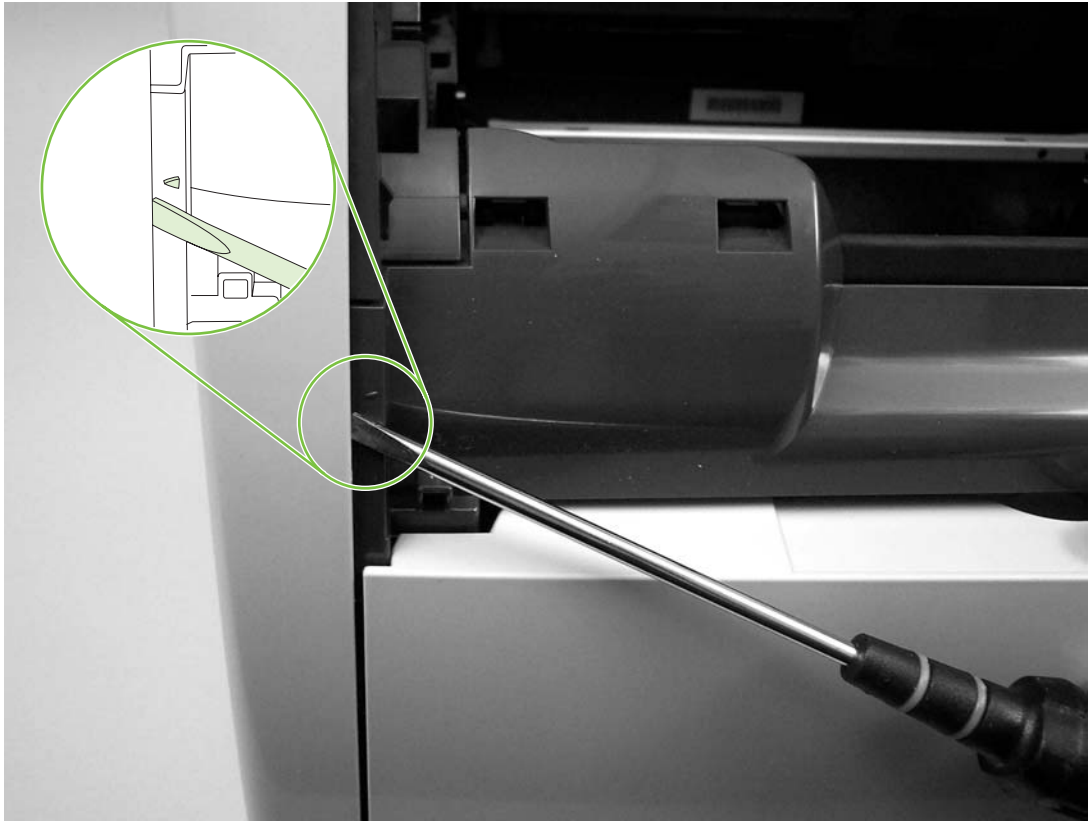

Figure 5-21 Disengage the left cover latch

- 3 Pull the bottom of the cover slightly up and out to release the bottom latches, and then pull up and away from the device to release the latches at the top of the cover.

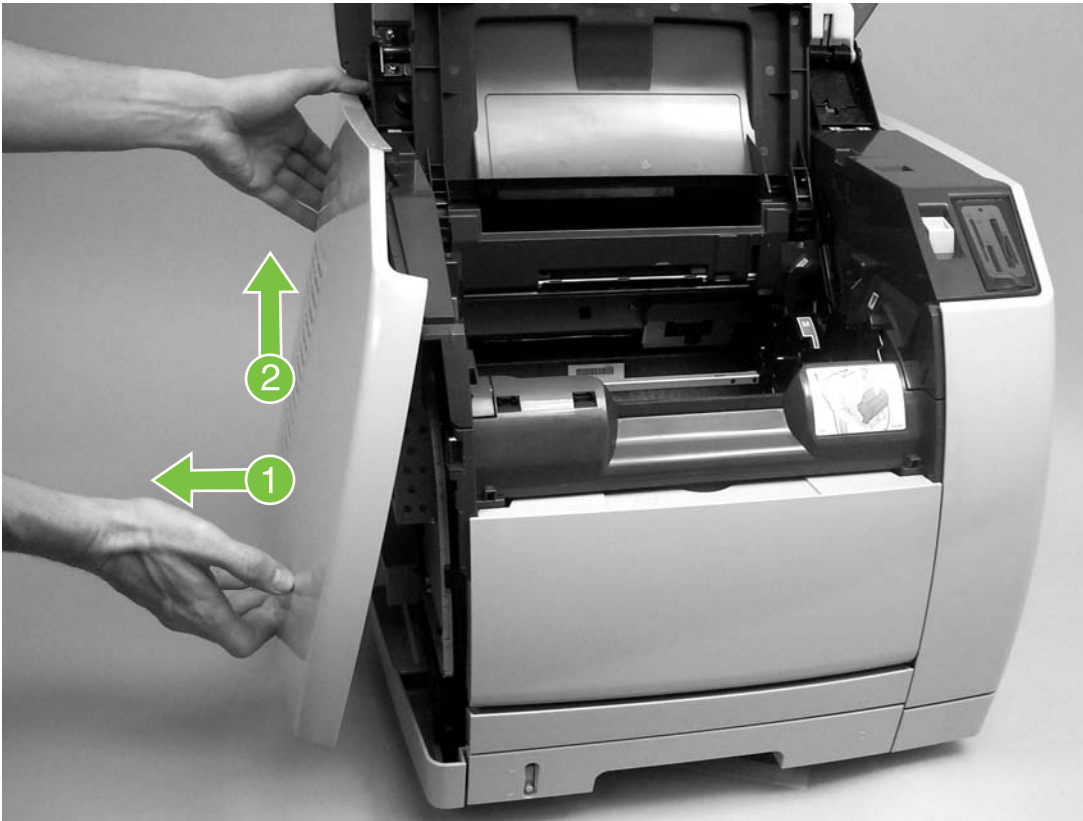

Figure 5-22 Pull the bottom of the cover

Removing the right cover

- 1 Remove the two screws (callout 1) from the lower edge of the cover.



Figure 5-23 Remove the right-side cover (1 of 2)

- 2 Open the scanning assembly, grasp the cover by the handle and by the top, and then pull the bottom of the cover and then up gently, rotating the cover away from the device as you lift it.



Figure 5-24 Remove the right-side cover (2 of 2)



Reinstallation tip When reinstalling the cover, reattach the tab that is closer to the back of the device before reattaching the front.

Removing optional tray 2 (250-sheet tray)



CAUTION This procedure requires lifting the device. The device is heavy. Hewlett-Packard recommends that two people lift the device off of tray 2.

- 1 Remove the right and left covers (see [Removing the right cover](#) and [Removing the left cover](#)).
- 2 Remove one screw (callout 1) from optional tray 2.

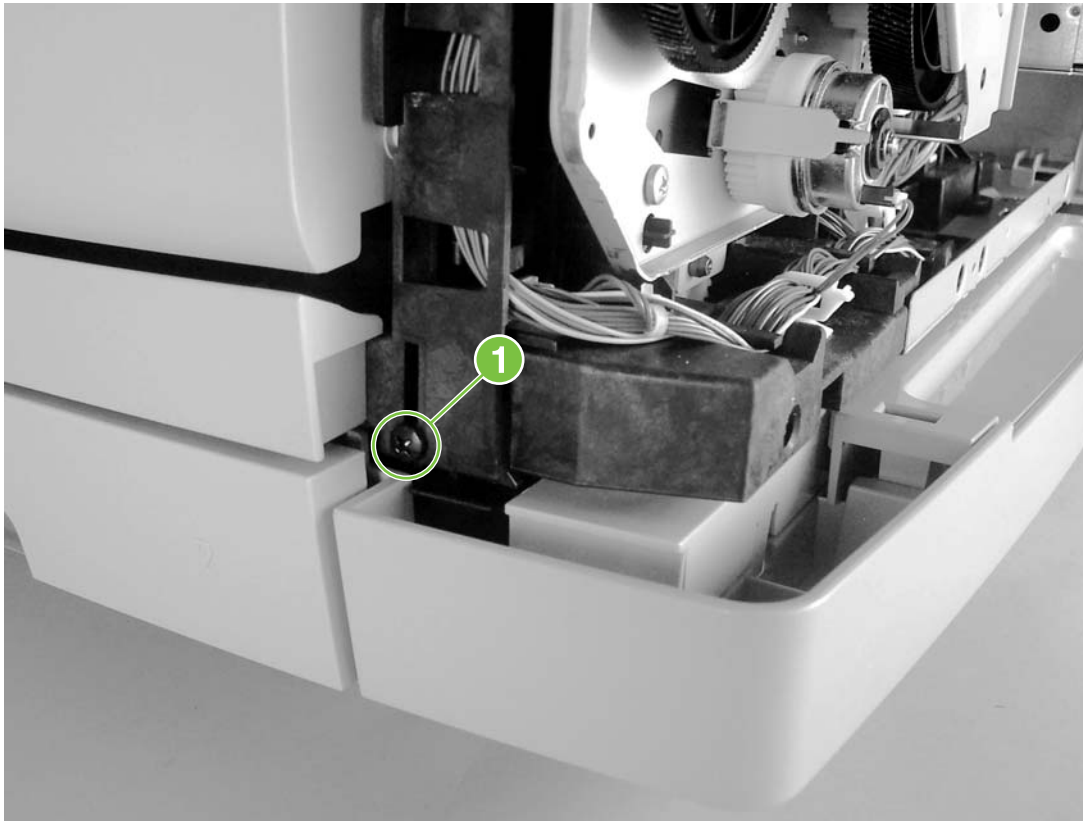

Figure 5-110 Remove optional tray 2 (1 of 2)

- 3 Remove one screw (callout 2) from the left side at the front of the device.

- 4 Remove two screws (callout 3) from the back of optional tray 2.

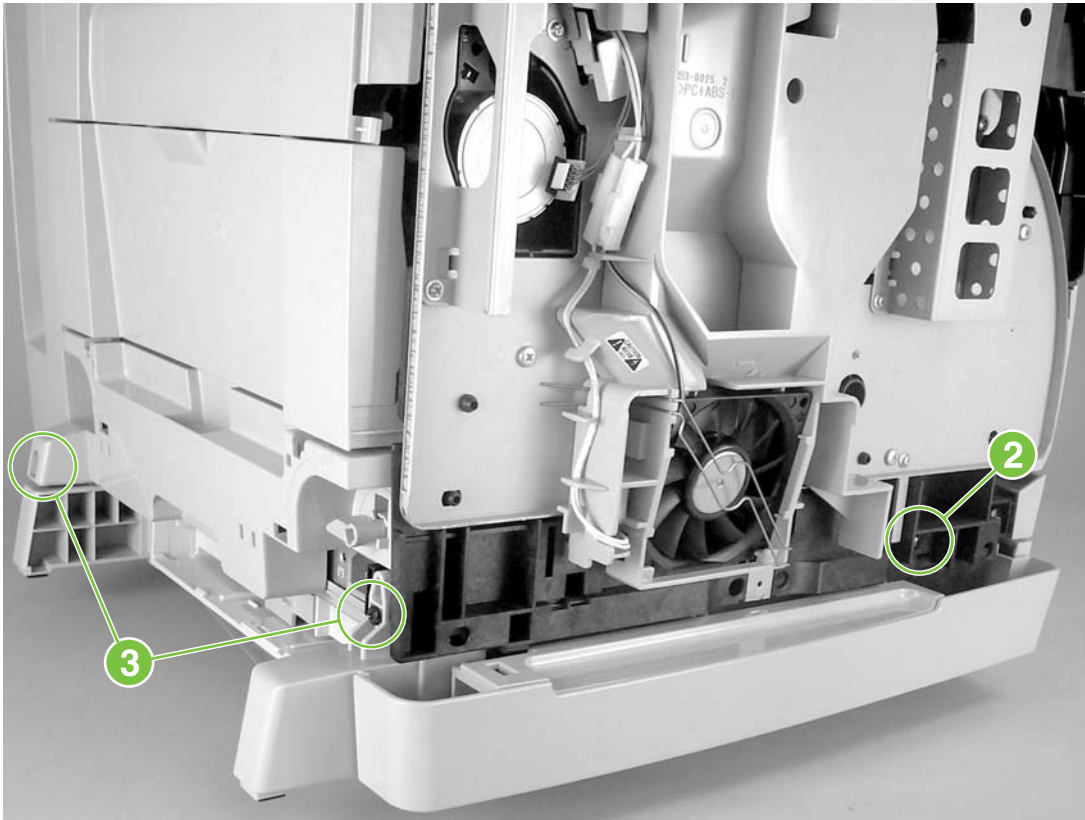

Figure 5-111 Remove optional tray 2 (2 of 2)

- 5 Grasp the device frame on each side, and then carefully lift the device off of tray 2.



Reinstallation tip When reinstalling optional tray 2, line up the posts on the bottom of the device with the slots in optional tray 2.

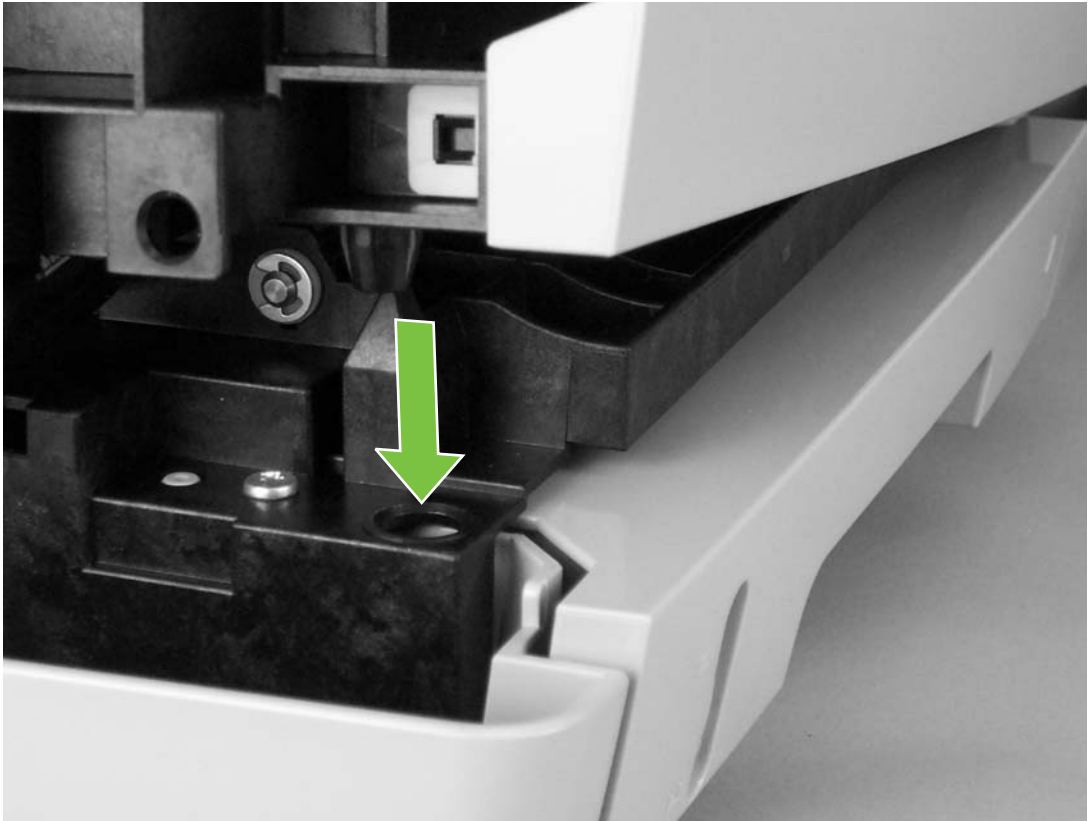

Figure 5-112 Reinstall tray 2

Removing the optional tray 2 pickup roller

- 1 Remove all paper from the 250-sheet feeder and then remove the 250-sheet feeder from the device.
- 2 Press the lift plate down and then pull the tray out of the feeder.
- 3 Turn the feeder upside-down.
- 4 Use a flatblade screwdriver to disengage the white, plastic lever, and then rotate the lever toward the front of the feeder to release the roller.

- 5 Lift the pickup roller up to remove it.

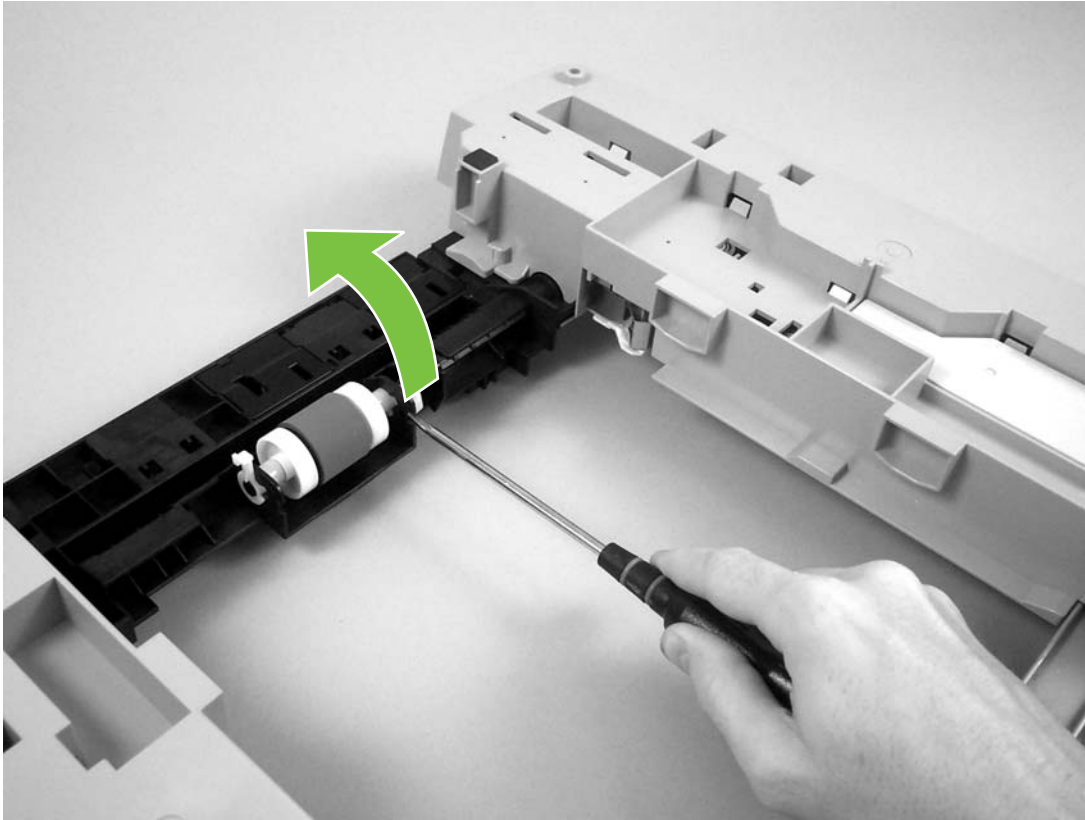
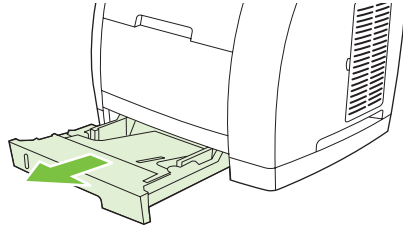

Figure 5-113 Remove the 250-sheet feeder pickup roller

Replacing the optional tray 2 separation pad

- 1 Remove the tray from the device and place it on a flat surface. Remove any paper from the tray.



- 2 Locate the separation pad in the base at the inside-front edge of the tray.

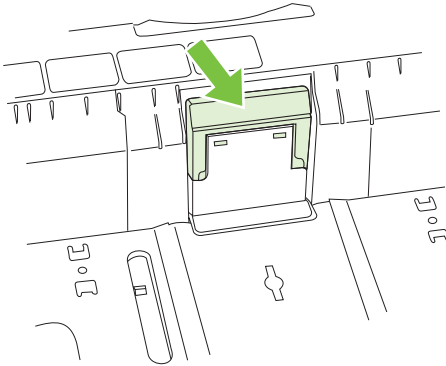

- 3 Press the large metal plate at the bottom of the tray down. Insert a flatblade screwdriver in the slots on each side of the base and push the tabs out of the slots.

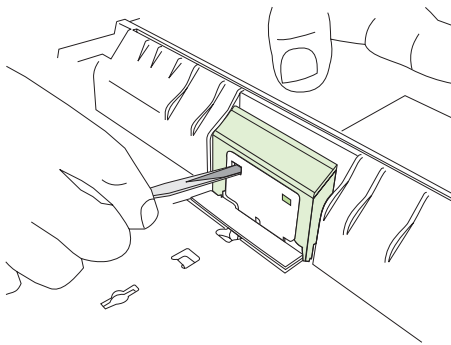

- 4 Pull the separation pad up and out of the tray.

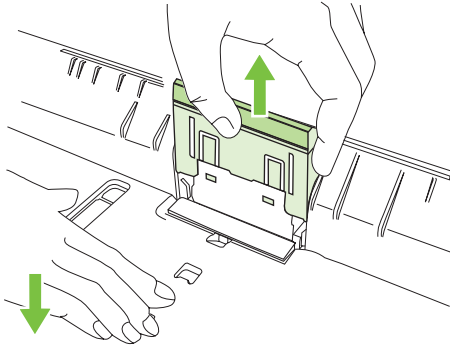

- 5 Use one hand to position the new separation pad above the empty base. Align the grooves on the sides of the pad with the sides of the base, and then slide the pad down until the tabs snap into the slots on the base.

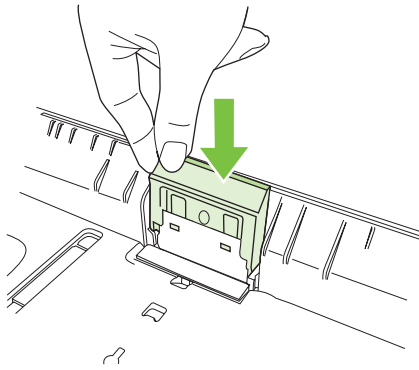

- 6 Reload any print media, and then slide the tray into the device.

